

# Support Units(Round)

## Fixed Side Precision Type



Code	Type	Material	Surface Treatment
LEB01	Precision Type Fixed Side	S50C	Black Oxide

No.	Part Name	Qty.
①	Oil Seal (Ø6-8 1pc.)	2
②	Bearing Housing	1
③	Angular Contact Bearing Class 5	1 Set
④	Cover	1
⑤	Collar	2
⑥	Clamping Nut	1
⑦	Set Screw (with copper sheet)	2

- ① Do not disassemble ②, ③ and ④, as they must remain assembled.
- ② Bearing is filled with low particle generation grease.
- ③ When tightening the nut and locking, be sure to pad a copper sheet, and the set screw needs to be added with anti-drop glue.
- ④ Uses the preloaded JIS 5 class Angular Contact Bearings. It is recommended to use for high-accuracy and high-speed precision applications.

d6~8

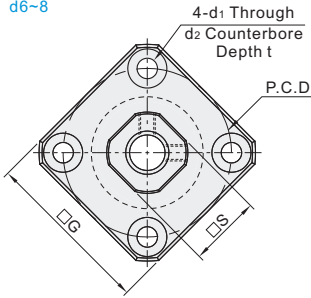

Installation Method A

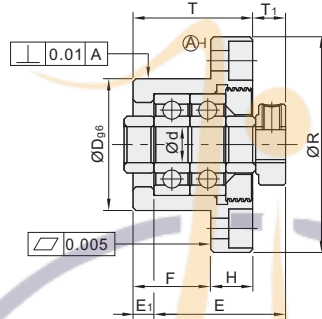

Installation Method B

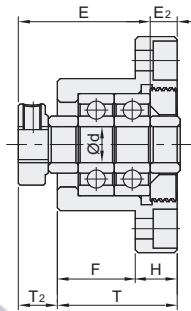

d10~30

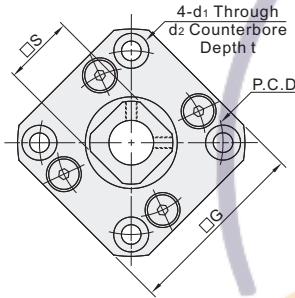

Installation Method A

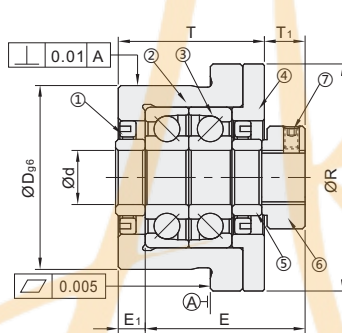

Installation Method B

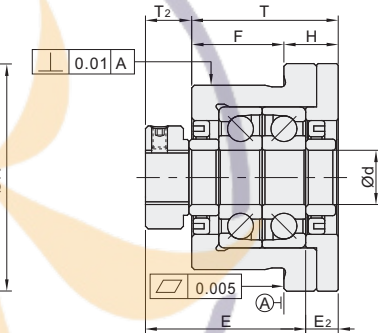

Advise shaft end machining dimensions

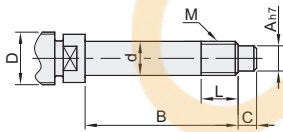

Installation Method A

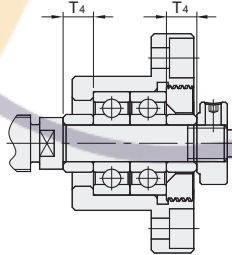

Installation Method B

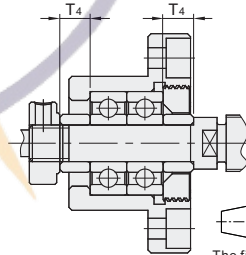

The first perspective

Part Number	Code	No.	Ød	T	H	F	E	ØDg6	R	P.C.D.	G	Installation Method A		Installation Method B		Ød1	Ød2	t	M1	S	Advise shaft end machining dimensions									
												T1	E1	T2	E2						Ball Screws Shaft Dia.		Shaft end O.D.		Shaft end machining dimensions		Nominal Thread		Collar Length Size	
																					ØD	Ød	ØA	B	C	M	L	T4		
6	6B	6	20	7	13	22	22 <sup>-0.007</sup> / <sub>-0.020</sub>	35	36	28	28	5.5	3.5	6.5	4.5	2.9	5.5	3.5			12	8	6 <sup>-0.007</sup> / <sub>-0.020</sub>	4	28	8	M6×P0.75	8	5	
8		8	23	9	14	26	28 <sup>-0.007</sup> / <sub>-0.020</sub>	43	35	35	7	4	8	5	3.4	6.5	4			M3	14	10/12	8 <sup>-0.007</sup> / <sub>-0.020</sub>		32	9	M8×P1.0	10		
10		10	27	10		29.5	34 <sup>-0.009</sup> / <sub>-0.025</sub>	52	42	42		7.5	5	8.5	6	4.5	8			M3	16	12/14/15	10 <sup>-0.005</sup> / <sub>-0.012</sub>	8	36	15	M10×P1.0		5.5	
12		12					36 <sup>-0.009</sup> / <sub>-0.025</sub>	54	44	44											M3	19	14/15/16	12 <sup>-0.005</sup> / <sub>-0.012</sub>	10	10				
15		15	32	15			40 <sup>-0.009</sup> / <sub>-0.025</sub>	63	50	52	10	6		12	8	5.5	9.5	6			M3	22	18/20	15 <sup>-0.005</sup> / <sub>-0.012</sub>	12	47	20	M15×P1.0	13	10
20		20	52	22		30	57 <sup>-0.010</sup> / <sub>-0.029</sub>	85	70	68	8		10		14	6.5	11	10			M4	30	25/28/30	20 <sup>-0.005</sup> / <sub>-0.012</sub>	17	62	25	M20×P1.0	17	11
25		25	57	27			63 <sup>-0.010</sup> / <sub>-0.029</sub>	98	80	79	13				20	17	9	15	13		M5	35	30/32/36	25 <sup>-0.005</sup> / <sub>-0.012</sub>	20	75	30	M25×P1.5	22	15
30		30	62	30	32	61	75 <sup>-0.010</sup> / <sub>-0.029</sub>	117	95	93	11	12	17	18	11	17.5	15				M6	40	36/40	30 <sup>-0.005</sup> / <sub>-0.012</sub>	25	68	38	M30×P1.5	25	9



Part Number		Ød	R
Code	No.		
LEB01	6	6	36
	8	8	43

LEB01 — 6



Discount price	
Per	1~9 10~
Price	100% Additional quotation



Delivery	
	6

Please order as shown

# Support Units(Round)

## Support Side Standard Type



Code	Type		Material			Surface Treatment		
			①	②	③	①		
LEB11	Standard Type	Support Side	S50C			Black Oxide		

No.	Part Name	Qty.
①	Bearing Housing	1
②	Deep Groove Ball Bearings Class 5	1
③	Retaining Ring C Type	1

- ⓘ Bearing is filled with low dust generation grease.
- ⓘ Bearing is Double Shielded.
- ⓘ Uses the preloaded JIS 5 class Deep Groove Ball Bearings. It is recommended to use high-accuracy and high-speed rotation applications.

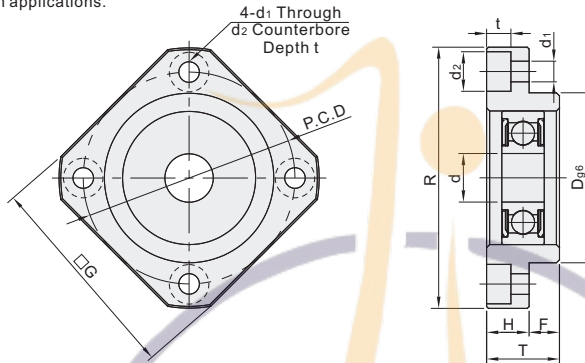

ⓘ Advise shaft end machining dimensions

Installation Method A

Installation Method B

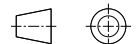
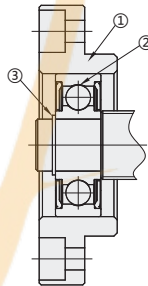
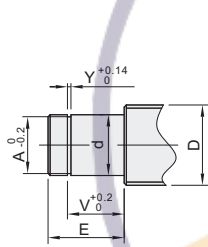

The first perspective

Part Number		Code	No.	Ød	T	H	F	ØD <sub>g6</sub>	R	P.C.D	G	Ød <sub>1</sub>	Ød <sub>2</sub>	t	Advise Shaft end Machining Dimensions						Retaining Ring C Type
Ball Screws Shaft Dia.	Shaft end O.D.														Size of retaining ring groove						
															ØD	Ød	ØA	E	V	Y	
LEB11	6	6	10	6	4	22 <sup>-0.007</sup> <sub>-0.020</sub>	36	28	28			3.4	6.5		8	6 <sup>-0.005</sup> <sub>-0.012</sub>	5.7	9	6.8	0.8	TBP01-6
	10	8	12		5	28 <sup>-0.007</sup> <sub>-0.020</sub>	43	35	35					4	12/14/15	8 <sup>-0.005</sup> <sub>-0.012</sub>	7.6	10	7.9	0.9	TBP01-8
	12	10	15	7		34 <sup>-0.007</sup> <sub>-0.025</sub>	52	42	42			4.5	8		14/15/16	10 <sup>-0.005</sup> <sub>-0.012</sub>	9.6	11	9.15	1.15	TBP01-10
	15	15	17	9	8	40 <sup>-0.007</sup> <sub>-0.025</sub>	63	50	52			5.5	9.5	5.5	18/20	15 <sup>-0.005</sup> <sub>-0.014</sub>	14.3	13	10.15		TBP01-15
	20	20	20	11	9	57 <sup>-0.010</sup> <sub>-0.029</sub>	85	70	68			6.6	11	6.5	25/28/30	20 <sup>-0.005</sup> <sub>-0.014</sub>	19	19	15.35	1.35	TBP01-20
	25	25	24	14	10	63 <sup>-0.010</sup> <sub>-0.029</sub>	98	80	79			9	14	8.5	30/32/36	25 <sup>-0.005</sup> <sub>-0.014</sub>	23.9	20	16.35		TBP01-25
	30	30	27	18	9	75 <sup>-0.010</sup> <sub>-0.029</sub>	117	95	93			11	17.5	11	36/40	30 <sup>-0.005</sup> <sub>-0.015</sub>	28.6	21	17.75	1.75	TBP01-30

Ball Screws Support Units E4



Part Number		Ød	R
Code	No.		
LEB11	6	6	36
LEB11	10	8	43

LEB11 — 6



Discount price	
Per	1~9 10~
Price	100% Additional quotation



Delivery
6

# Support Units(Square)

## Fixed Side Precision Type



Code	Type	Material				Surface Treatment			
		①	③	④	⑥	①	③	④	⑥
LEB21	Precision Type   Fixed Side	S50C				Black Oxide			

No.	Part Name	Qty.
①	Bearing Housing	1
②	Angular Contact Bearing Class 5	1 Set
③	Cover	1
④	Collar	2
⑤	Oil Seal(d=8 comes with one oil seal)	2
⑥	Clamping Nut	1
⑦	Hex Socket Head Cap Screw	2

- ❗ Do not disassemble ①, ② and ③, as they must remain assembled.
- ❗ Bearing is filled with low particle generation grease.
- ❗ When tightening the nut and locking, be sure to pad a copper sheet, and the set screw needs to be added with anti-drop glue.
- ❗ Uses the preloaded JIS 5 class Angular Contact Bearings. It is recommended to use high-accuracy and high-speed precision applications.

d6~8

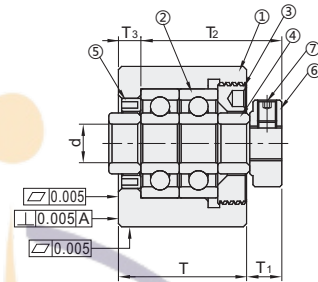
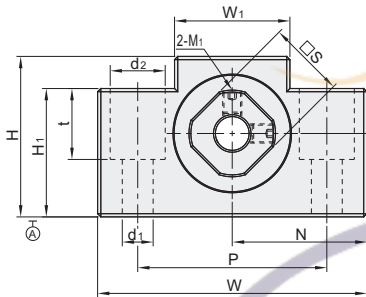

d10~20

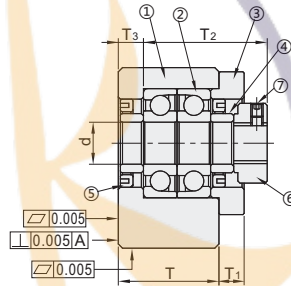
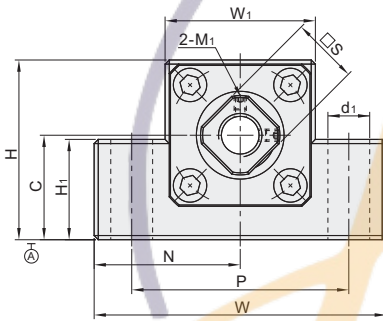

☑ Advise shaft end machining dimensions

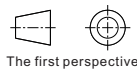
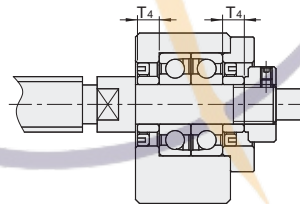
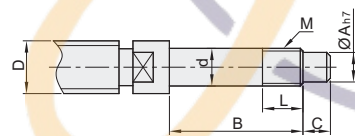

Code	No.	Part Number														Advise Shaft end Machining Dimensions											
		Ød	T	T <sub>1</sub>	T <sub>2</sub>	T <sub>3</sub>	W	H	C	W <sub>1</sub>	H <sub>1</sub>	P	N	Ød <sub>1</sub>	Ød <sub>2</sub>	t	M <sub>1</sub>	S	Ball Screws Shaft Dia.	Shaft end O.D.	Shaft end machining dimensions			Nominal Thread	Collar Length Size		
																				ØD	Ød	ØA	B	C	M(Fine)	L	T <sub>4</sub>
LEB21	6	6	20	5.5	22	3.5	42	25	13	18	20	30	21	5.5	9.5	11		12	8	6 <sup>+0.005</sup> <sub>-0.012</sub>	4	28	8	M6×P0.75	8	5	
	8	8	23	7	26	4	52	32	17	25	26	38	26	6.6	11	12		14	10/12	8 <sup>+0.005</sup> <sub>-0.012</sub>	6	32	9	M8×P1.0	10		
	10	10	24	6	29.5	6	70	43	25	36	24	52	35	9				M3	16	12/14/15	10 <sup>+0.005</sup> <sub>-0.012</sub>	8	36	15	M10×P1.0	11	5.5
	12	12																									
	15	15	25		32	5	80	49	30	41		25	60	40					22	18/20	15 <sup>+0.005</sup> <sub>-0.014</sub>	12	47	20	M15×P1.0	18	6
20	20	42	10	50	10	95	58	30	56			75	47.5					M4	30	25/28/30	20 <sup>+0.005</sup> <sub>-0.014</sub>	17	62	25	M20×P1.0	17	11



Part Number		Ød	T
Code	No.		
LEB21	6	6	20
	8	8	23

LEB21 — 6



Discount price	
Per	1~9 10~
Price	100% Additional quotation



Delivery
6

# Support Units(Square)

## Support Side Standard Type



Code	Type		Material	Surface Treatment
			① ③	④
LEB31	Standard Type	Support Side	S50C	Black Oxide

No.	Part Name	Qty.
①	Bearing Housing	1
②	Deep Groove Ball Bearings Class 5	1
③	Retaining Ring C Type	1

- ⓘ Bearing is filled with low particle generation grease.
- ⓘ Bearing is Double Shielded.
- ⓘ Uses the preloaded JIS 5 class Deep Groove Ball Bearings. It is recommended to use high-accuracy and high-speed rotation applications.

d=6~8

d=10~25

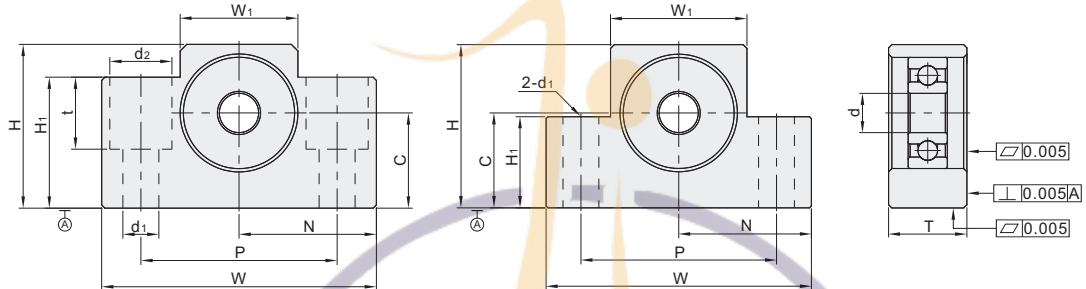

☑ Advise shaft end machining dimensions

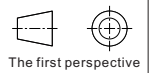
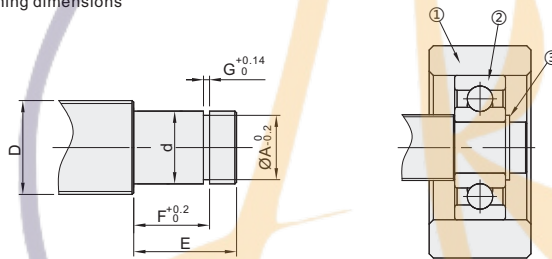

Part Number		Ød	T	W	H	C	W <sub>1</sub>	H <sub>1</sub>	P	Ød <sub>1</sub>	Ød <sub>2</sub>	t	N	Advise Shaft end Machining Dimensions						Retaining Ring C Type
Code	No.													Ball Screws Shaft Dia.		Shaft end O.D.		Size of retaining ring groove		
														±0.02	ØD	Ød	ØA	E	F	
LEB31	6	6	12	42	25	13	18	20	30	5.5	9.5	11	21	8	6 <sup>-0.005</sup> <sub>-0.012</sub>	5.7	9	6.8	0.8	TBP01-6
	8	6	14	52	32	17	25	26	38	6.6	11	12	26	10	8 <sup>-0.005</sup> <sub>-0.012</sub>	7.6	10	7.9	0.9	TBP01-8
	10	8	20	70	43	25	36	24	52	9				12/14/15	10 <sup>-0.005</sup> <sub>-0.012</sub>	9.6	11	9.15	1.15	TBP01-10
	12	10		14/15/16	10 <sup>-0.005</sup> <sub>-0.012</sub>	9.6	11	9.15												
	15	15	80	49	41	60	25	60	75	11	40	18/20	15 <sup>-0.005</sup> <sub>-0.014</sub>	14.3	13	10.15	TBP01-15			
	15B		50	30	25	60	30	75	11	40	18/20	15 <sup>-0.005</sup> <sub>-0.014</sub>	14.3	13	10.15	TBP01-15				
	20	20	26	95	58	56	30	75	11	40	18/20	15 <sup>-0.005</sup> <sub>-0.014</sub>	14.3	13	10.15	TBP01-20				
	20B		26	95	58	56	30	75	11	40	18/20	15 <sup>-0.005</sup> <sub>-0.014</sub>	14.3	13	10.15	TBP01-20				
	25	25	30	105	68	35	66	25	85	52.5	32/36	25 <sup>-0.005</sup> <sub>-0.014</sub>	23.9	20	16.35	TBP01-25				

Ball Screws Support Units E4



Part Number		Ød	T
Code	No.		
LEB31	6	6	12
	8	6	14

LEB31 — 6



Discount price	
Per	Price
1~9	100%
10~	Additional quotation



Delivery	
6	

# Support Units(Square)

## Fixed Side Economy Type



Code	Type	Material				Surface Treatment			
		①	③	④	⑥	①	③	④	⑥
LEBA41	Economy Type Fixed Side	S50C				Black Oxide			

No.	Part Name	Qty.
①	Bearing Housing	1
②	Angular Contact Bearing Class 5	1 Set
③	Cover	1
④	Collar	2
⑤	Set Screw (with copper sheet)	2
⑥	Clamping Nut	1
⑦	Oil Seal(d<8 comes with one oil seal)	2

- ❗ Do not disassemble ①, ② and ③, as they must remain assembled.
- ❗ Bearing is filled with low particle generation grease.
- ❗ When tightening the nut and locking, be sure to pad a copper sheet, and the set screw needs to be added with anti-drop glue.
- ❗ Uses the preloaded JIS 5 class Angular Contact Bearings. It is recommended to use high-accuracy and high-speed precision applications.

d6~8

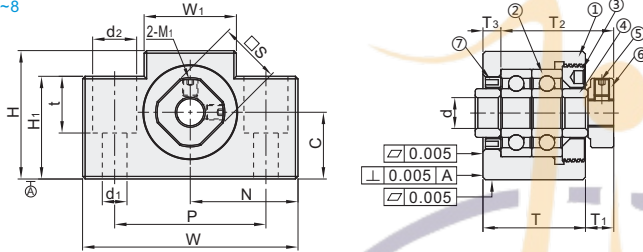

d10~15

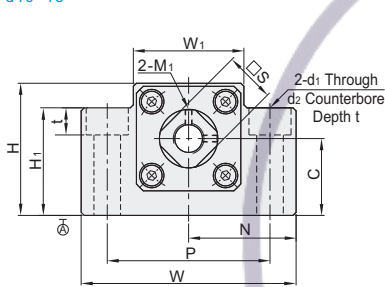

d20

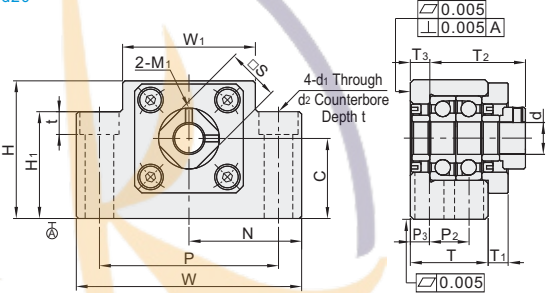

d25

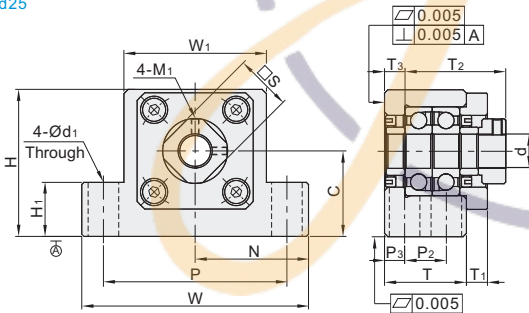

❗ Advise shaft end machining dimensions

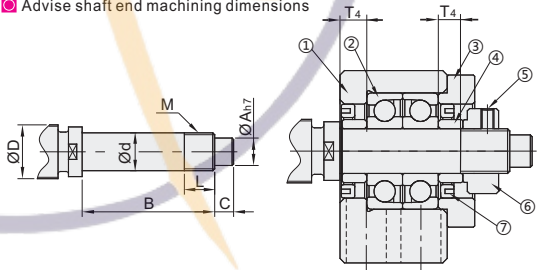

The first perspective

Part Number	Code	No.	Ød	T	T1	T2	T3	W	H	C	W1	H1	P	N	P2	P3	Ød1	Ød2	t	M1	S	Advise Shaft end Machining Dimensions							
																						Ball Screws Shaft Dia.	Shaft end O.D.	Shaft end machining dimensions			Nominal Thread	Collar Length Size	
										$\pm 0.02$				$\pm 0.02$								ØD	Ød	ØA	B	C	M(Fine)	L	T4
6	6	6	20	5.5	22	3.5	42	25	13	18	20	30	21				5.5	9.5	11	12	12	8/10	$6_{-0.005}^{+0.012}$	5	27	8	M6×P0.75	6	5
8	8	8	23	7	26	4	52	32	17	25	26	38	26				6.6	11	12	14	10/12	$8_{-0.005}^{+0.012}$	6.5	31.5	7.5	M8×P1.0	7		
10	10	10	24	6	29.5	6	70	43	25	36	35	52	35				9	14	11	M3	16	$12_{-0.005}^{+0.012}$ / $14_{-0.005}^{+0.012}$	8	36	15	M10×P1.0	11	5.5	
12	12	12	24	6	29.5	6	70	43	25	36	35	52	35				9	14	11	M3	19	$14_{-0.005}^{+0.012}$ / $15_{-0.005}^{+0.012}$ / $16_{-0.005}^{+0.012}$	10	36	15	M12×P1.0			
15	15	15	25		32	5	80	49	30	41	40	60	40				11	17	15	M4	22	$18_{-0.005}^{+0.012}$ / $20_{-0.005}^{+0.014}$	12	47	20	M15×P1.0	18	6	
20	20	20	42	10	50	10	95	58	30	56	45	75	47.5	22	10		11	17	15	M4	30	$25_{-0.005}^{+0.014}$ / $28_{-0.005}^{+0.014}$ / $30_{-0.005}^{+0.014}$	17	62	25	M20×P1.0	17	11	
25	25	25	48	13	60	14	105	68	35	66	25	85	52.5	30	9		11			M5	35	$30_{-0.005}^{+0.014}$ / $32_{-0.005}^{+0.014}$ / $36_{-0.005}^{+0.014}$	22	75	18	M25×P1.5	22	15	



Part Number	Code	No.	Ød	T
LEBA41	6	6	20	
	8	8	23	

LEBA41 — 6



Discount price  
Per 1~9 10~  
Price 100% Additional quotation



Delivery  
6

Code	Type	Material	Surface Treatment
		① ③	①
LEB51	Economy Type   Support Side	S50C	Black Oxide

No.	Part Name	Qty.
①	Bearing Housing	1
②	Deep Groove Ball Bearings Class 5	1
③	Retaining Ring C Type	1

- ① Bearing is filled with low particle generation grease.
- ② Bearing is Double Shielded.
- ③ Uses the preloaded JIS 5 class Deep Groove Ball Bearings. It is recommended to use high-accuracy and high-speed rotation applications.

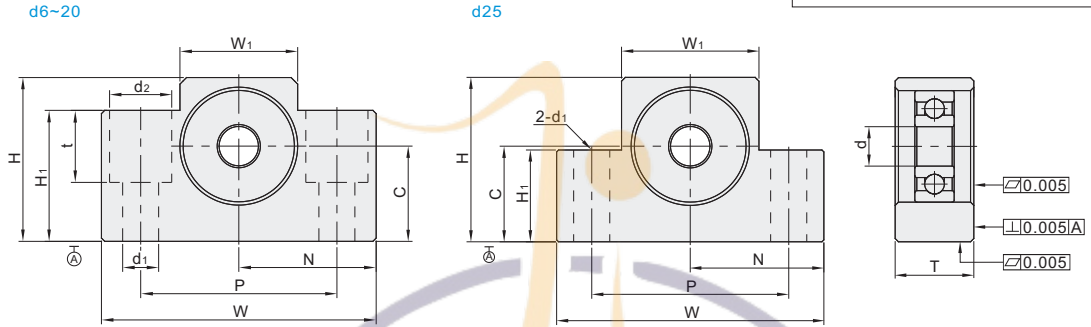

Advise shaft end machining dimensions

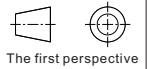
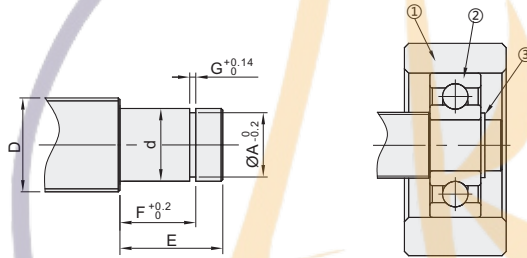

Code	Part Number No.	Ød	T	W	H	C	W <sub>1</sub>	H <sub>1</sub>	P	Ød <sub>1</sub>	Ød <sub>2</sub>	t	N	Advise Shaft end Machining Dimensions					Retaining Ring C Type	
														Ball Screws Shaft Dia.	Shaft end O.D.	Size of retaining ring groove				
														ØD	Ød	ØA	E	F	G	
LEB51	6	6	12	42	25	13	18	20	30	5.5	9.5	11	21	8	6 <sup>-0.005</sup> <sub>-0.012</sub>	5.7	9	6.8	0.8	TBP01-6
	8	6	14	52	32	17	25	26	38	6.5	11	12	26	8/10	8 <sup>-0.005</sup> <sub>-0.012</sub>	7.6	10	7.9	0.9	TBP01-8
	10	8	20	70	43	25	36	35	52	9	14	11	35	12/14/15	10 <sup>-0.005</sup> <sub>-0.012</sub>	9.6	11	9.15	1.15	TBP01-10
	12	10		80	49	30	41	40	60	9				14/15/16	10 <sup>-0.005</sup> <sub>-0.012</sub>	9.6	11	9.15		TBP01-10
	15	15	30	80	49	30	41	40	60	9	17	15	47.5	18/20	15 <sup>-0.005</sup> <sub>-0.014</sub>	14.3	13	10.15	1.35	TBP01-15
	20	20		26	95	58	56	45	75	11				25/28/30	20 <sup>-0.005</sup> <sub>-0.014</sub>	19	19	15.35		TBP01-20
	25	25		30	105	68	35	66	25	85				11	-	-	52.5	28/30/32		25 <sup>-0.005</sup> <sub>-0.015</sub>



Part Number		Ød	T
Code	No.		
LEB51	6	6	12
	8	6	15

LEB51 — 6



Discount price	
Per	1~9 10~
Price	100% Additional quotation



# Support Units(Square)

## Fixed Side Side Hole Type



Code	Type		Material				Surface Treatment			
			①	③	④	⑥	①	③	④	⑥
LEB61	Side Hole Type	Fixed Side	S50C				Black Oxide			

  

No.	Part Name	Qty.
①	Bearing Housing	1
②	Angular Contact Bearing Class 5	1 Set
③	Cover	1
④	Collar	2
⑤	Set Screw (with copper sheet)	2
⑥	Bearing Nut	1
⑦	Oil Seal(d-8 comes with one oil seal)	2

- ❗ Do not disassemble ①, ② and ③, as they must remain assembled.
- ❗ Bearing is filled with low particle generation grease.
- ❗ When tightening the nut and locking, be sure to pad a copper sheet, and the set screw needs to be added with anti-drop glue.
- ❗ Uses the preloaded JIS 5 class Angular Contact Bearings. It is recommended to use high-accuracy and high-speed rotation applications.

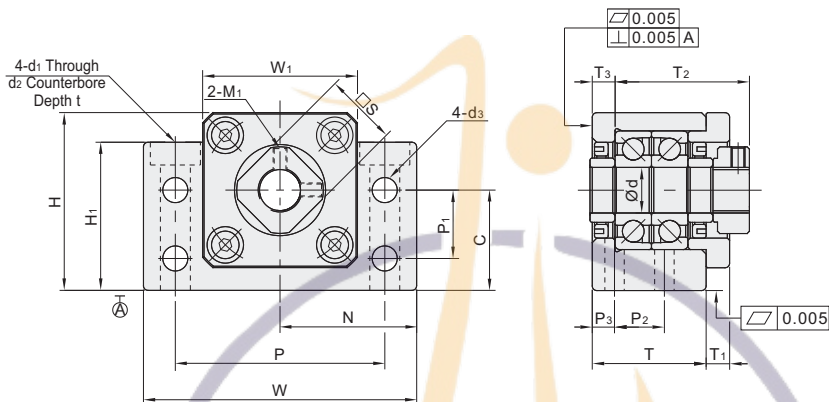

☑ Advise shaft end machining dimensions

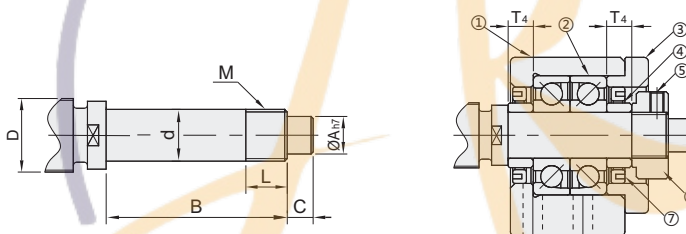

The first perspective

Part Number	Code	No.	Ød	T	T <sub>1</sub>	T <sub>2</sub>	T <sub>3</sub>	W	H	C	W <sub>1</sub>	H <sub>1</sub>	P	P <sub>1</sub>	P <sub>2</sub>	P <sub>3</sub>	Ød <sub>1</sub>	Ød <sub>2</sub>	t	N	Ød <sub>3</sub>	M <sub>1</sub>	S	Advise Shaft end Machining Dimensions						
																								Ball Screws Shaft Dia.	Shaft end O.D.	Shaft end machining dimensions			Nominal Thread	Collar Length Size
																							ØD	ØD	ØA	B	C	M(Fine)	L	T <sub>4</sub>
LEB61	10	10	25	5	29.5	5	60	39	22	34	32.5	46	15	13	6	6.6	11	1.5	5	30	16	M3	12/14/15	10 <sup>-0.005</sup> <sub>-0.012</sub>	8	36	15	M10×P1.0	16	5.5
	12	12	5	29.5	5	60	43	25	35	32.5	46	18	13	6	6.6	11	1.5	5.5	M3	19	14/15/16	12 <sup>-0.005</sup> <sub>-0.012</sub>	10	36	15	M12×P1.0	14	5.5		
	15	15	27	6	32	6	70	48	28	40	38	54	18	15	6	6.6	11	1.5	6.5	35	22	18/20	15 <sup>-0.005</sup> <sub>-0.014</sub>	12	40	20	M15×P1.0	12	6	
	17	17	35	9	44	7	86	64	39	50	55	68	28	19	8	9	14	1.5	8.6	43	24	20/25	17 <sup>-0.005</sup> <sub>-0.014</sub>	15	53	23	M17×P1.0	17	7	
	20	20	35	8	43	8	88	60	34	52	50	70	22	19	8	9	14	1.5	8.5	44	30	25/28	20 <sup>-0.005</sup> <sub>-0.014</sub>	17	53	25	M20×P1.0	15	8	
	25	25	42	12	54	9	106	80	48	64	70	85	33	22	10	11	17.5	11	53	9	M5	32/36	25 <sup>-0.005</sup> <sub>-0.014</sub>	20	65	30	M25×P1.5	18	9	
	30	30	45	14	61	9	128	89	51	76	78	102	33	23	11	14	20	13	64	11	M6	40	36/40	30 <sup>-0.005</sup> <sub>-0.015</sub>	25	72	38	M30×P1.5	25	9

Ball Screws  
Support Units  
E4



Please order as shown

Part Number		Ød	T
Code	No.		
LEB61	10	10	25
	12	12	25

LEB61 — 10



Discount price		
Per	1~9	10~
Price	100%	Additional quotation



Delivery	
6	



Code	Type	Material	Surface Treatment
			① ② ③
LEB71	Side Hole Type   Support Side	S50C	Black Oxide

No.	Part Name	Qty.
①	Bearing Housing	1
②	Deep Groove Ball Bearings Class 5	1
③	Retaining Ring C Type	1

- ① Bearing is filled with low particle generation grease.
- ② Bearing is Double Shielded.
- ③ Uses the preloaded JIS 5 class Deep Groove Ball Bearings. It is recommended to use high-accuracy and high-speed rotation applications.

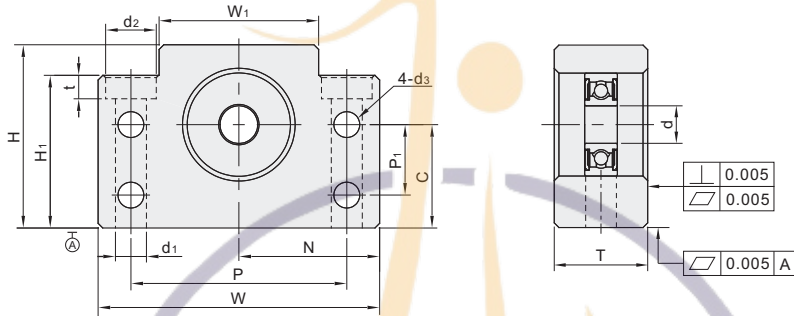

Advise shaft end machining dimensions

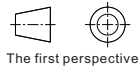
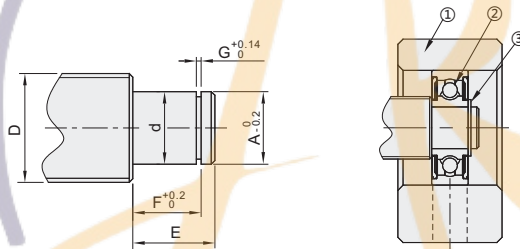

Code	Part Number No.	Advise Shaft end Machining Dimensions														Retaining Ring C Type						
		Ød	T	W	H	C	W1	H1	P	P1	Ød1	Ød2	t	Ød3	N		Size of retaining ring groove					
																	Ball Screws Shaft Dia.	Shaft end O.D.	ØA	E	F	G
LEB71	10	8		60	39	22	34	32.5	46	15			5		30	12/14/15	8 <sup>-0.005</sup> / <sub>-0.012</sub>	7.6	10	7.9	0.9	TBP01-8
	12	10	20		43	25	35			18	6.6	11	1.5	5.5	30	14/15/16	10 <sup>-0.005</sup> / <sub>-0.012</sub>	9.6	11	9.15		TBP01-10
	15	15		70	48	28	40	38	54				6.5		35	18/20	15 <sup>-0.005</sup> / <sub>-0.014</sub>	14.3	13	10.15	1.15	TBP01-15
	17	17	23	86	64	39	50	55	68	28					43	20/25	17 <sup>-0.005</sup> / <sub>-0.014</sub>	16.2	16	13.15		TBP01-17
	20	20	26	88	60	34	52	50	70	22	9	14	8.5	6.6	44	25/28/30	20 <sup>-0.005</sup> / <sub>-0.014</sub>	19	19	13.35		TBP01-20
	25	25	30	106	80	48	64	70	85	33	11	17.5	11	9	53	30/32/36	25 <sup>-0.005</sup> / <sub>-0.014</sub>	23.9	20	16.35	1.35	TBP01-25
	30	30	32	128	89	51	76	78	102	33	14	20	13	11	64	36/40	30 <sup>-0.005</sup> / <sub>-0.015</sub>	28.6	21	17.75	1.75	TBP01-30



Part Number Code	Part Number No.	Ød	T
LEB71	10	8	20
LEB71	12	10	

LEB71 - 10



Discount price	Per	1~9	10~
Price	100%	Additional quotation	



Delivery	6
----------	---



# Clamping Nut/Collar

## Clamping Nut

Code	Type	Material	Surface Treatment
LEB81	Clamping Nut	S50C	Black Oxide

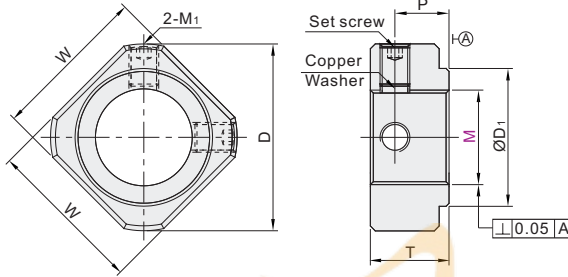

Part Number	P Pitch	W	T	ØD	ØD <sub>1</sub>	P	M <sub>1</sub>
LEB81	M6	0.75	12	5	14.5	9	M3
	M8	1.0	14	6.5	17	13	2.7
	M10		16	8	19	14	5.5
M12	19		8	22	17	5.5	
LEB81	M15	1.5	22	13	25	21	M4
	M17		24	13	30	25	9.5
	M20		30	11	35	26	7
	M25		35	15	43	33	10
LEB81	M30	40	20	48	39	14	M6



Part Number	P Pitch	W
LEB81 — M8	1.0	14
LEB81 — M10	1.0	16



Discount price
per 1~9 10~
Price 100% Additional quotation



## Collar

Code	Type	Material	Surface Treatment
LEB91	Collar	S50C	Black Oxide

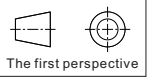
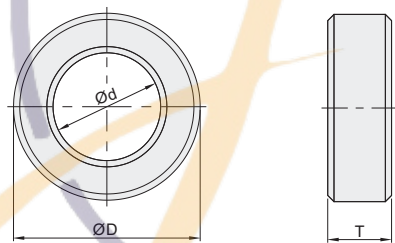

Part Number	Ød	ØD	T	
LEB91	6	9.4	5	
	8	11.4	5.5	
	10	14.4		
	12	15.4	6	
	15	19.4		
	15B	15		10
	17	24.4	7	
	17B	17	15	
	20	29.4	8	
	20B	20	11	
	20C	29.4	15	
	25	9	15	
	25B	25		15
	25C	25		18
	30	39.4	9	
	30B	30	18	



Part Number	Ød	ØD
LEB91 — 6	6	9.4
LEB91 — 8	8	11.4



Discount price
Per 1~9 10~
Price 100% Additional quotation



Ball Screws Support Units E4