

Locating Pins

Round/Diamond Large Head Tapered

Code	Type	D Tol.	Material		Hardness	Surface Treatment
			GB	Equiv.		
YBP01	Round	Dm6	9CrWMn	SKS3	Quenching Hardness:58-61HRC	—
YBP11		Dp6				
YBR01	Diamond	Dm6				
YBR11		Dp6				

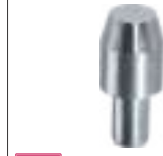

Self-made

Round
YBP01
YBP11

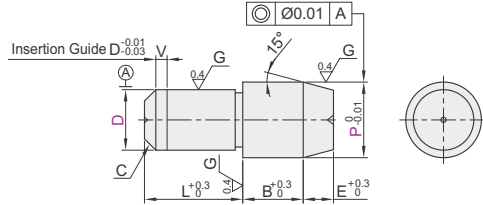

Diamond
YBR01
YBR11

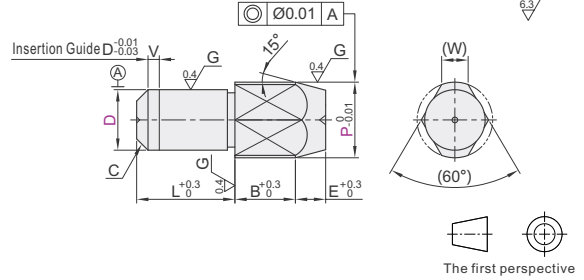

Round

Part Number Code	D	D Tol.		P	L	B	C	E	V
		m6	p6						
Dm6 YBP01	1			2	3	3	0.1	0.5	0
	2	+0.008	+0.012	3 4	4	3	0.5	1	0
	3	+0.002	+0.006	4 5 6	5	5		2	
	4			5 6	6	6			
	5	+0.012	+0.020	6 8	10	6	1	3	
	6	+0.004	+0.012	8 10	10	8	1.5		1
Dp6 YBP11	8	+0.015	+0.024	10 12 13	15	8			
	10	+0.006	+0.015	12 13 15	15	10	2	4	
	12			13 15 16	22	10	3	5	2
	13	+0.018	+0.029	15 16					
	16	+0.007	+0.018	16 20 25					
	20	+0.021	+0.035	25 30	30	15			

Diamond

Part Number Code	D	D Tol.		P	L	B	C	E	V	(W)
		m6	p6							
Dm6 YBR01	1			2	3	3	0.1	0.5	0	0.6
	2	+0.008	+0.012	3 4	4	3	0.5	1		1.2
	3	+0.002	+0.006	4 5 6	5	5	2			1.5
	4			5 6	6	6	1	3		1.8
	5	+0.012	+0.020	6 8	10	6	1	3		2.2
	6	+0.004	+0.012	8 10	10	8			1	3
Dp6 YBR11	8	+0.015	+0.024	10 12 13	15	8	1.5			3.5
	10	+0.006	+0.015	12 13 15	15	10	2	4		4
	12			13 15 16	22	10	3	5	2	5
	13	+0.018	+0.029	15 16						5.5
	16	+0.007	+0.018	16 20 25						7
	20	+0.021	+0.035	25 30	30	15	3	5	2	9

Optional Processing

EC() Changes the E Dimension

Ordering Code: EC2

□ 1 mm Inc.
 □ B+E≥EC+2 (Straight Part min. 2 mm)
 □ P/2-EC × tan 15° (=0.27) > 0.5 (Tip Ø1.0 min.)
 □ B Dimension changes when EC is specified.

D	EC	D	EC
2	2~5	8	5~16
3	3~9	10	
4	4~11	12	5~22
5	4~11	13	
6	4~13	16	6~23
		20	

Optional Processing

MA Adds a Tapped Hole

Ordering Code: MA

D	MA	V1
6	M3	4
8~13	M4	6
16~20	M6	9

RC Changes the Relief to R0.5

Ordering Code: RC

□ P-D ≤ 2 not applicable.

Round

Part Number	D	D Tol.	P
Code	D	m6	p6
YBP01	2	+0.008	3 4
YBP11	3	+0.002	4 5 6

YBP01—D2—P4

Diamond

Part Number	D	D Tol.	P
Code	D	m6	p6
YBR01	2	+0.008	3 4
YBR11	3	+0.002	4 5 6

YBR01—D3—P6—RC

Discount price

Per	1~4	5~
Price	100%	Additional quotation

Delivery

11

Locating Pins

with Tapped Shank Large Head Tapered

Code	Type	Material		Hardness	Surface Treatment
		GB	Equiv.		
YBU41	Round	9CrWMn	SKS3	Treated Hardness:58-61HRC	-
YBU48		9Cr18Mo	SUS440C	Treated Hardness:48-53HRC	
YBU51	Diamond	9CrWMn	SKS3	Treated Hardness:58-61HRC	
YBU58		9Cr18Mo	SUS440C	Treated Hardness:48-53HRC	



Round
YBU41
YBU48

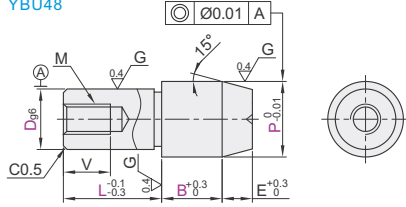

Diamond
YBU51
YBU58

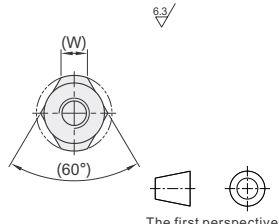
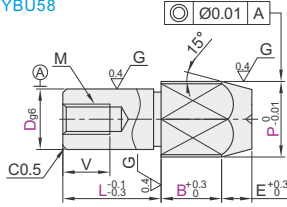

① SUS440C Stainless Steel has an identification groove on D part.

Round

Part Number	0.01 mm Inc.	1 mm Inc.	0.1 mm Inc.	E	M	V
Code	D _{g6}	P	L	B		
5	5.50~10.00	5~12	1.5~15.0	3	M2	3
6	6.50~10.00	6~15	1.5~15.0	3	M3	5
8T	8.50~15.00	8~18	1.5~30.0		M4	6
8	8.50~15.00	8~18	1.5~30.0		M5	8
10T	11.00~20.00	6~18			M4	6
10	11.00~20.00	10~22	3.0~30.0	4	M5	8
12T	13.00~20.00	8~20			M4	6
12	13.00~20.00	12~26			M5	8
13T	14.00~20.00	8~22			M6	9
13	14.00~20.00	13~28			M8	10
16T	17.00~30.00	10~26	5.0~30.0		M6	9
16	17.00~30.00	16~35			M8	12
20T	22.00~30.00	12~32		5	M6	9
20	22.00~30.00	20~42			M8	12

Diamond

Part Number	0.01 mm Inc.	1 mm Inc.	0.1 mm Inc.	E	(W)	M	V
Code	D _{g6}	P	L	B			
5	5.50~10.00	9~12	1.5~15.0	3	2.2	M2	3
6	6.50~10.00	9~15	1.5~15.0	3	3	M3	5
8T	8.50~15.00	12~18	1.5~30.0		3.5	M4	6
8	8.50~15.00	12~18	1.5~30.0		3.5	M5	8
10T	11.00~20.00	12~18			4	M4	6
10	11.00~20.00	12~22	3.0~30.0	4	4	M5	8
12T	13.00~20.00	12~20			5	M4	6
12	13.00~20.00	12~26			5	M5	8
13T	14.00~20.00	14~22			5.5	M6	9
13	14.00~20.00	14~28			5.5	M8	10
16T	17.00~30.00	14~26	5.0~30.0		7	M6	9
16	17.00~30.00	16~35			7	M8	12
20T	22.00~30.00	18~32		5	9	M6	9
20	22.00~30.00	20~42			9	M8	12

Round

Part Number	P	L	B
Code	D _{g6}		
YBU41	6.5~10	8~18	1.5~15
YBU48	8	8~18	1.5~30

Optional Processing

Part Number	P	L	B	Optional Processing Code
Code	D _{g6}			
YBU41	6.5~10	8~18	1.5~15	EC()
YBU48	8	8~18	1.5~30	EC()



Discount price	Per	1~19	20~
Price	100%	Additional quotation	



Delivery 11

Please order as shown

YBU41-D6-P8-L8-B10

YBU41-D6-P10-L8-B10-RC



Code	Spec.																																																												
EC()	<p>Changes the E Dimension</p> <p>Ordering Code EC4</p> <table border="1"> <thead> <tr> <th>D</th> <th>EC</th> <th>D</th> <th>EC</th> </tr> </thead> <tbody> <tr> <td>1 mm Inc.</td> <td>6 4~13</td> <td>13</td> <td>5~22</td> </tr> <tr> <td>Small cone diameter 1 min.</td> <td>8 5~16</td> <td>16</td> <td>6~23</td> </tr> <tr> <td>B Dimension changes when EC is specified.</td> <td>10 5~22</td> <td>20</td> <td></td> </tr> <tr> <td></td> <td>12</td> <td></td> <td></td> </tr> </tbody> </table>	D	EC	D	EC	1 mm Inc.	6 4~13	13	5~22	Small cone diameter 1 min.	8 5~16	16	6~23	B Dimension changes when EC is specified.	10 5~22	20			12																																										
D	EC	D	EC																																																										
1 mm Inc.	6 4~13	13	5~22																																																										
Small cone diameter 1 min.	8 5~16	16	6~23																																																										
B Dimension changes when EC is specified.	10 5~22	20																																																											
	12																																																												
RC	<p>Changes the Relief to R0.5</p> <p>Ordering Code RC</p> <p>① P-D ≤ 2 not applicable.</p>																																																												
TA	<p>Increase the wrench hole</p> <p>Ordering Code TA</p> <table border="1"> <thead> <tr> <th>D</th> <th>Applicable Size</th> <th>Wrench Hole Size</th> </tr> <tr> <td></td> <td>B</td> <td>P Q</td> </tr> </thead> <tbody> <tr> <td>5</td> <td></td> <td>5.50~9.99 2</td> </tr> <tr> <td>6 6T</td> <td></td> <td>10.00~16.00 3.5</td> </tr> <tr> <td>8 8T</td> <td>5.0~</td> <td>17.00~ 5</td> </tr> <tr> <td>10 10T</td> <td></td> <td></td> </tr> <tr> <td>12 12T</td> <td></td> <td></td> </tr> <tr> <td>13 13T</td> <td></td> <td></td> </tr> <tr> <td>16 16T</td> <td>10.0~</td> <td></td> </tr> <tr> <td>20 20T</td> <td></td> <td></td> </tr> </tbody> </table> <p>① Orientation between diamond shape head and wrench hole is arbitrary. ② Combination with EC, RC and SA is not available.</p>	D	Applicable Size	Wrench Hole Size		B	P Q	5		5.50~9.99 2	6 6T		10.00~16.00 3.5	8 8T	5.0~	17.00~ 5	10 10T			12 12T			13 13T			16 16T	10.0~		20 20T																																
D	Applicable Size	Wrench Hole Size																																																											
	B	P Q																																																											
5		5.50~9.99 2																																																											
6 6T		10.00~16.00 3.5																																																											
8 8T	5.0~	17.00~ 5																																																											
10 10T																																																													
12 12T																																																													
13 13T																																																													
16 16T	10.0~																																																												
20 20T																																																													
SA	<p>Increase the hexagonal hole</p> <p>Ordering Code SA</p> <table border="1"> <thead> <tr> <th>D</th> <th colspan="3">Applicable Size</th> <th colspan="2">Hex Hole Size</th> </tr> <tr> <td></td> <td>P</td> <td>L</td> <td>B</td> <td>F</td> <td>S</td> </tr> </thead> <tbody> <tr> <td>5</td> <td>6.00~</td> <td>8~</td> <td>6.0~</td> <td>2</td> <td>2</td> </tr> <tr> <td>6 6T</td> <td>6.50(8.00)~</td> <td>10~</td> <td>6.0~</td> <td>2</td> <td>3</td> </tr> <tr> <td>8 8T</td> <td>8.00(10.00)~</td> <td>10~</td> <td>10.0~</td> <td>2.5</td> <td>4</td> </tr> <tr> <td>10 10T</td> <td>11.00(12.00)~</td> <td>12~</td> <td>10.0~</td> <td>3</td> <td>5</td> </tr> <tr> <td>12 12T</td> <td>13.0~</td> <td>12~</td> <td>12.0~</td> <td></td> <td></td> </tr> <tr> <td>13 13T</td> <td>14.0~</td> <td>15~</td> <td>15.0~</td> <td>4</td> <td>6</td> </tr> <tr> <td>16 16T</td> <td>17.0~</td> <td>16~</td> <td>15.0~</td> <td></td> <td></td> </tr> <tr> <td>20 20T</td> <td>22.0~</td> <td>20~</td> <td>15.0~</td> <td>5</td> <td>8</td> </tr> </tbody> </table> <p>① P dimension in () is applicable to diamond shape. ② Combination with EC, RC and TA is not available.</p>	D	Applicable Size			Hex Hole Size			P	L	B	F	S	5	6.00~	8~	6.0~	2	2	6 6T	6.50(8.00)~	10~	6.0~	2	3	8 8T	8.00(10.00)~	10~	10.0~	2.5	4	10 10T	11.00(12.00)~	12~	10.0~	3	5	12 12T	13.0~	12~	12.0~			13 13T	14.0~	15~	15.0~	4	6	16 16T	17.0~	16~	15.0~			20 20T	22.0~	20~	15.0~	5	8
D	Applicable Size			Hex Hole Size																																																									
	P	L	B	F	S																																																								
5	6.00~	8~	6.0~	2	2																																																								
6 6T	6.50(8.00)~	10~	6.0~	2	3																																																								
8 8T	8.00(10.00)~	10~	10.0~	2.5	4																																																								
10 10T	11.00(12.00)~	12~	10.0~	3	5																																																								
12 12T	13.0~	12~	12.0~																																																										
13 13T	14.0~	15~	15.0~	4	6																																																								
16 16T	17.0~	16~	15.0~																																																										
20 20T	22.0~	20~	15.0~	5	8																																																								

Locating Pins

Hex Socket Large Head Tapered, With Threaded Shank

Code	Type	Material		Hardness	Surface Treatment
		GB	Equiv.		
YCC06	Round	0Cr18Ni9	SUS304	—	—
YCC26	Diamond				



Self-made

Round
YCC06

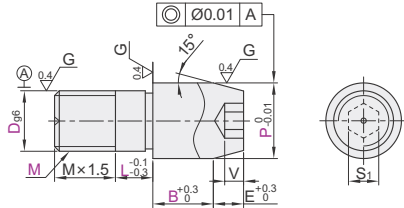

Diamond
YCC26

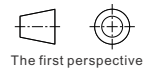
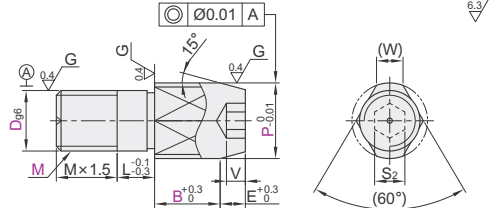

The first perspective

Round

Part Number		0.01 mm Inc.	1 mm Inc.	0.1 mm Inc.	M	E	S ₁	V
Code	D _{g6}	P	L	B				
YCC06	3	-0.002 -0.008	6.00~6.50	2~8	3.5~10.0	3	2	
	4		6.50~7.00	2~10	2.5~10.0	3 4		
	5	-0.004 -0.012	6.50~8.00			3 4 5	3	2
	6		6.50~10.00	3~12	2.5~12.0	4 5 6		
	8	-0.005 -0.014	9.00~13.00	5~12	3.0~15.0	4 5 6 8		2.5
	10		11.00~15.00	5~17	4.5~20.0	5 6 8 10	4	3
	12	-0.006 -0.017	13.00~18.00	8~17	6.0~20.0	6 8 10 12		4
	16		17.00~25.00	8~22	8.0~20.0	8 10 12 16	5	5
20	-0.007 -0.020	22.00~30.00	10~22		10 12 16 20		8	

Diamond

Part Number		0.01 mm Inc.	1 mm Inc.	0.1 mm Inc.	M	E	(W)	S ₂	V
Code	D _{g6}	P	L	B					
YCC26	6	-0.004 -0.012	8.00~10.00	3~12	2.5~12.0	4 5 6	3	3	2
	8	-0.005 -0.014	10.00~13.00	5~12	3.0~15.0	4 5 6 8		3.5	2.5
	10		12.00~15.00	5~17	4.5~20.0	5 6 8 10	4	4	3
	12	-0.006 -0.017	13.00~18.00	8~17	6.0~20.0	6 8 10 12		5	4
	16		17.00~25.00	8~22	8.0~20.0	8 10 12 16	5	7	
	20	-0.007 -0.020	22.00~30.00	10~22		10 12 16 20		9	5



Part Number	D _{g6}	P	L	B	M
YCC06	3	6~6.5	2~8	3.5~10	3
YCC06	4	6.5~7	2~10	2.5~10	3 4

YCC06—D3—P6—L4—B5—M3

Optional Processing

Part Number	D _{g6}	P	L	B	M	Optional Processing Code
YCC06	3	6~6.5	2~8	3.5~10	3	MD
YCC06	4	6.5~7	2~10	2.5~10	3 4	MD

YCC06—D4—P7—L4—B10—M3—MD



Optional Processing

Code	Spec.
MD	<p>Adds a Relief at the Thread End</p> <p>Ordering Code MD Undercut length is approx. Pitch×2.</p>



Discount price
Per 1~9 10~
Price 100% Additional quotation



Delivery
8

Locating Pins

Standard

Large Head Tapered, Tolerance Selectable

Code	Type	Material		Hardness	Surface Treatment
		GB	Equiv.		
YCJ08	Round	9Cr18Mo	SUS440C	Treated Hardness:48-53 HRC	—
YCJ18	Diamond				

Tolerance Selection

D or P	g6	h7	m6	p6	S
2.00~3.00	-0.002 -0.008	0 -0.010	+0.008 +0.002	+0.012 +0.006	
3.01~6.00	-0.004 -0.012	0 -0.012	+0.012 +0.004	+0.020 +0.012	
6.01~10.00	-0.005 -0.014	0 -0.015	+0.015 +0.006	+0.024 +0.015	0 -0.01
10.01~18.00	-0.006 -0.017	0 -0.018	+0.018 +0.007	+0.029 +0.018	
18.01~30.00	-0.007 -0.020	0 -0.021	+0.021 +0.008	+0.035 +0.022	

When D=P, no relief is applied, and there are two forms:

When D = P and tolerances are different.

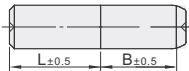

When D = P and tolerances are the same.

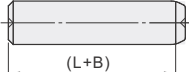

When D = P, Diamond-shape end has a relief.



Round
YCJ08

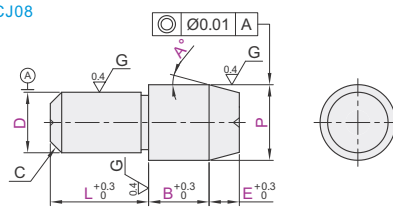

Diamond
YCJ18

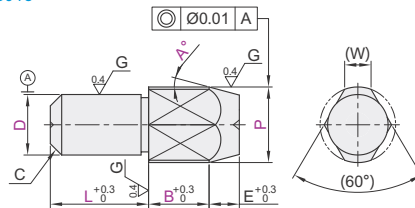

Self-made

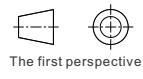

Code	D Tol.	P Tol.	0.01 mm Inc.				1 mm Inc.		0.1 mm Inc.		A	C	(W)	
			D	P	L	B	E	L	B	E				
Round YCJ08	m6	s	1	1.00~3.00	2~3	1.5~5.0					0.1	0.6		
			2	2.00~6.00	2~8						0.5	1.2		
			3	3.00~10.00	3~10							1.5		
			4	4.00~10.00	3~15	1.5~15.0						1.8		
			5	5.00~12.00	5~15						15	1	2.2	
			6	6.00~12.00	5~15						30		3	
			8	8.00~16.00	5~20	1.5~30.0	0.5~15.0					1.5	3.5	
			10	10.00~18.00	5~22							45		4
	Diamond YCJ18	g6	h7	12	12.00~20.00	6~26	3.0~30.0					2	5	
				13	13.00~20.00	7~28							5.5	
				16	16.00~27.00	8~35	5.0~30.0						7	
				20	20.00~30.00	10~42							3	9



Please order as shown

Part Number		0.01 mm Inc.	1 mm Inc.	0.1 mm Inc.	A		
Code	D Tol. P Tol.	D	P	L	B	E	A
YCJ08	m6 p6	6	8-16	5-20	1.5-30	0.5-15	15

YCJ08—m6—p6—D6—P8—L10—B10—E8—A30



Discount price
Per 1~19 20~
Price 100% Additional quotation

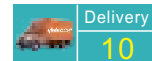

Delivery 10

Optional Processing

Part Number		0.01 mm Inc.	1 mm Inc.	0.1 mm Inc.	A	Optional Processing Code	
Code	D Tol. P Tol.	D	P	L	B	E	A
YCJ08	m6 p6	6	8-16	5-20	1.5-30	0.5-15	30

YCJ08—m6—p6—D6—P8—L10—B10—E8—A45—MA



Optional Processing

Code	Spec.	Code	Spec.																		
MA	<p>Adds a Tapped Hole</p> <p>Ordering Code MA</p> <table border="1"> <thead> <tr> <th>D</th> <th>MA</th> <th>V1</th> </tr> </thead> <tbody> <tr> <td>6</td> <td>M3</td> <td>4</td> </tr> <tr> <td>8~13</td> <td>M4</td> <td>6</td> </tr> <tr> <td>16~20</td> <td>M6</td> <td>9</td> </tr> </tbody> </table>	D	MA	V1	6	M3	4	8~13	M4	6	16~20	M6	9	DB	<p>Adds Insertion Guide</p> <p>Ordering Code DB</p> <table border="1"> <thead> <tr> <th>D</th> <th>V1</th> </tr> </thead> <tbody> <tr> <td>3~12</td> <td>1</td> </tr> <tr> <td>13~20</td> <td>2</td> </tr> </tbody> </table>	D	V1	3~12	1	13~20	2
D	MA	V1																			
6	M3	4																			
8~13	M4	6																			
16~20	M6	9																			
D	V1																				
3~12	1																				
13~20	2																				
RC	<p>Changes the Relief to R0.5</p> <p>Ordering Code RC</p> <p>P-D ≤ 2 not applicable.</p>	DC	<p>Additional Vent</p> <p>Ordering Code DC</p>																		

Double Pilot ▶ Large Head Tapered

Locating Pins

Standard

Code	Type	Tolerance Grade	Material		Hardness	Surface Treatment
			GB	Equiv.		
YCL01	Standard	D _{m6}	9CrWMn	SKS3	Treated Hardness: 58-61HRC	—

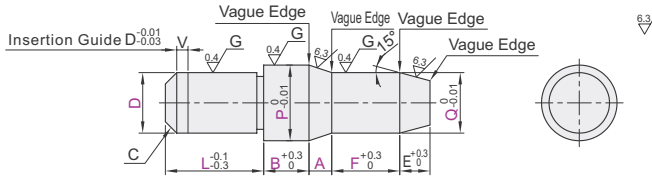

P < Q not applicable.

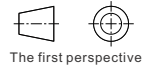

Code	Part Number	0.01 mm Inc.		1 mm Inc.	0.1 mm Inc.		E	C	V		
		D _{m6}	P	Q	L	B				A	F
YCL01	2	+0.008 +0.002	2.00~4.00	1.00~3.00	2~8	2.0~6.0	1.0~3.0	2.0~6.0	1	0.3	0.5
	3		3.00~6.00	1.00~5.00	3~8	2.0~10.0	1.0~5.0	2.0~10.0	2	0.5	
	4		4.00~7.00	2.00~6.00	4~10	2.0~15.0	1.0~8.0	2.0~15.0			1.5
	5	+0.012 +0.004	5.00~8.00	2.00~7.00	5~12				3	1	
	6		6.00~10.00	2.00~9.00	6~15	2.0~20.0		2.0~20.0			
	8	+0.015 +0.006	8.00~13.00	3.00~12.00	8~18					1.5	
	10		10.00~15.00	3.00~14.00	10~22		1.0~10.0		4	2	2.5
	12	+0.018 +0.007	12.00~16.00	5.00~15.00	12~26	3.0~20.0		3.0~20.0			
	16		16.00~25.00	10.00~24.00	16~35						
	20	+0.021 +0.008	20.00~30.00	13.00~29.00	20~42	5.0~20.0		5.0~20.0	5	3	



Please order as shown

Part Number	0.01 mm Inc.	1 mm Inc.	0.1 mm Inc.
Code	D P Q L B A F		
YCL01	3 3~6 1~5 3~8 2~10 1~5 2~10		

YCL01—D2—P3—Q2—L3—B5—A2—F3



no tax price ¥

Discount price	per	1~19	20~
Price	100%	Additional quotation	



Delivery 10

Tapped

Code	Type	Tolerance Grade	Material		Hardness	Surface Treatment
			GB	Equiv.		
YCL31	Tapped	D _{g6}	9CrWMn	SKS3	Treated Hardness: 58-61HRC	—

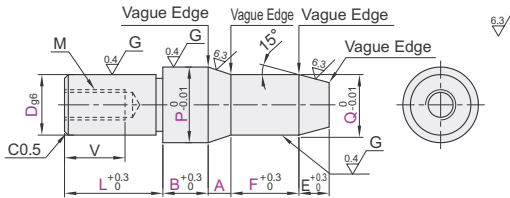

P < Q not applicable.

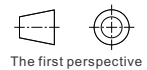

Code	Part Number	0.01 mm Inc.		1 mm Inc.	0.1 mm Inc.		E	M	V		
		D _{g6}	P	Q	L	B				A	F
YCL31	6	-0.004 -0.012	6.00~10.00	2.00~9.00	6~15	2.0~20.0			3	M3	5
	8	-0.005 -0.014	8.00~13.00	3.00~12.00	8~18	2.0~20.0				M4	
	10		10.00~15.00	3.00~14.00	10~22	3.0~20.0	1.0~10.0		4	M5	8
	12	-0.006 -0.017	12.00~16.00	5.00~15.00	12~26						
	16		16.00~25.00	10.00~24.00	16~35						
	20	-0.007 -0.020	20.00~30.00	13.00~29.00	20~42	5.0~20.0		5.0~20.0	5	M8	12



Please order as shown

Part Number	0.01 mm Inc.	1 mm Inc.	0.1 mm Inc.
Code	D P Q L B A F		
YCL31	8 8~13 3~12 8~18 2~20 1~13 2~26		

YCL31—D6—P8—Q7—L10—B10—A2—F5



no tax price ¥

Discount price	per	1~19	20~
Price	100%	Additional quotation	



Delivery 10

Locating Pins

with Tapped Shank Small Head Tapered

Code	Type	Material		Hardness	Surface Treatment
		GB	Equiv.		
YCY42	Round	9CrWMn	SKS3	Treated Hardness:58-61HRC, Plating Hardness:850HV~	Hard Chrome Plating , Plating Thickness:3~5 μm
YCY62	Diamond				

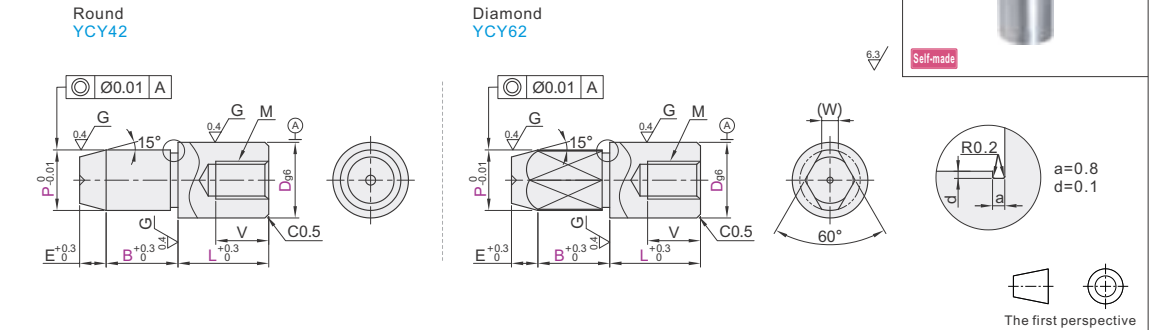

Round

Code	Part Number	D _{g6}	0.01 mm Inc.	1 mm Inc.	0.1 mm Inc.	E	M	V
			P	L	B			
YCY42	5		3.00~5.00	8~12	2.0~10.0	2	M2	3
	6	-0.012	4.00~6.00	8~18	2.0~15.0		M3	5
	8T		6.00~8.00	11~21	2.0~30.0		M4	6
	8					3	M5	8
	10T	-0.005	7.00~10.00	8~23			M4	6
	10	-0.014		11~23	3.0~30.0		M5	8
	12T		7.00~12.00	8~23		4	M4	6
	12			12~26			M5	8
	13T	-0.006	8.00~13.00	10~23			M6	9
	13	-0.017		13~28		5	M8	10
	16T		10.00~16.00	10~26	5.0~30.0		M6	9
	16			16~35			M8	12
20T	-0.007		12~32		6	M6	9	
20	-0.020	13.00~20.00	20~42			M8	12	

Diamond

Code	Part Number	D _{g6}	0.01 mm Inc.	1 mm Inc.	0.1 mm Inc.	E	(W)	M	V
			P	L	B				
YCY62	5		3.00~5.00	8~12	2.0~10.0	2	1.2	M2	3
	6	-0.004	4.00~6.00	9~18	2.0~15.0		1.5	M3	5
	8T		6.00~8.00	12~21	2.0~30.0		1.8	M4	6
	8					3		M5	8
	10T	-0.005	7.00~10.00	12~23			2.2	M4	6
	10	-0.014		12~23	3.0~30.0			M5	8
	12T		7.00~12.00	12~23		4	2.5	M4	6
	12			12~26				M5	8
	13T	-0.006	8.00~13.00	14~23			3	M6	9
	13	-0.017		14~28		5		M8	10
	16T		10.00~16.00	14~26	5.0~30.0		4	M6	9
	16			16~35				M8	12
20T	-0.007		18~32		6		M6	9	
20	-0.020	13.00~20.00	20~42				M8	12	

Round

Part Number	0.01 mm Inc.	1 mm Inc.	0.1 mm Inc.
Code D _{g6} P L B			
YCY42 5 -0.012 3-5 8-12 2-10			
6 -0.004 4-6 9-18 2-15			

YCY42 - D5 - P5 - L10 - B8

Optional Processing

Part Number	0.01 mm Inc.	1 mm Inc.	0.1 mm Inc.	Optional Processing Code
Code D _{g6} P L B				
YCY42 5 -0.012 3-5 8-12 2-10				RC EC()
6 -0.004 4-6 9-18 2-15				

YCY42 - D5 - P5 - L10 - B8 - EC4



Discount price
Per 1~19 20~
Price 100% Additional quotation

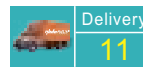

Code	Spec.
RC	Changes the Relief to R0.5 [Ordering Code] RC D-P≤2 not applicable.

Code	Spec.
EC()	Changes the E Dimension [Ordering Code] EC2 ① 1 mm Inc. ② B+E≥EC+2 (Straight Part min. 2 mm) ③ P/2-EC × tan 15° (=0.27) > 0.5 (Tip Ø1.0 min.) ④ B Dimension changes when EC is specified.

D	EC	D	EC
5	3~7	12	4~20
6	3~9	13	4~21
8	4~13	16	
10	4~16	20	5~22

Locating Pins ◀ Bolt Fixing

Code	Type	Material		Hardness	Surface Treatment
		GB	Equiv.		
YDF11	Bolt Fixing	9Cr18Mo	SUS440C	Treated Hardness:48-53HRC	—

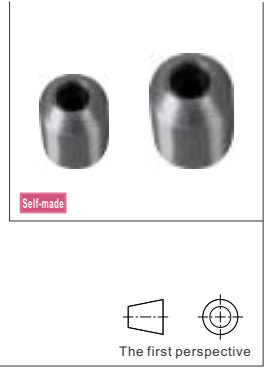
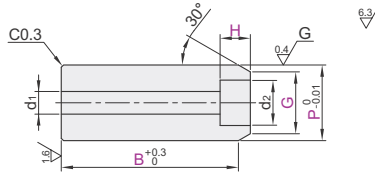

Part Number		0.01 mm Inc.	0.1 mm Inc.	1 mm Inc.	H	d1	d2	Applicable Screw
Code	No.	P	B	G				
YDF11	3	11.00~18.00	10.0~28.0	9≤G≤P	4	3.5	6.5	M3
	4	12.00~22.00	10.0~28.0	10≤G≤P	5	4.5	8	M4
	5	14.00~22.00	10.0~32.0	12≤G≤P	6	5.5	9.5	M5
	6	15.00~28.00	12.0~42.0	13≤G≤P	7	6.5	11	M6
	8	18.00~28.00	14.0~52.0	16≤G≤P	9	9	14	M8



Part Number		0.01 mm Inc.	0.1 mm Inc.	1 mm Inc.
Code	No.	P	B	G
YDF11	3	11~18	10~28	9≤G≤P
	4	12~22	10~28	10≤G≤P

YDF11—3—P13—B20—G12



Discount price	
Per	1~19 20~
Price	100% Additional quotation



Delivery
10

Code	Type	Material		Hardness	Surface Treatment
		GB	Equiv.		
YDJ46	Tapped	0Cr18Ni9	SUS304	—	—

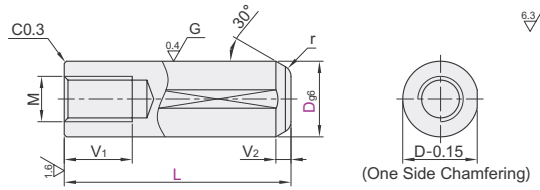

Code	Part Number		L	M	V ₁	V ₂	r
	D _{g6}						
YDJ46	5	-0.004	10 12 15 20 25 30	M3	6		
	6	-0.012	10 12 15 20 25 30	M4	8	1.0	1.0
	8	-0.005	10 12 15 20 25 30	M5		1.5	1.5
	10	-0.014	15 20 25 30	M6	10	2.0	2.0
	12	-0.006 -0.017	15 20 25 30				

- ① When D=6 and L=10, V₁=6.
- ② When L-V₁<6, The pilot hole for tapping may go through.



Part Number			L		
Code	D _{g6}		10	12	15 20
YDJ46	5	-0.004	10	12	15 20
	6	-0.012	10	12	15 20

YDJ46—D6—L12



Discount price		
Per	1~19	20~
Price	100%	Additional quotation

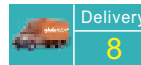

Straight/With Shoulder ▶ Anti-Shedding Type

Bushings for Locating Pins

□ Straight

Code	Type	Tolerance Grade	Material		Hardness	Surface Treatment
			GB	Equiv.		
YEL01	Straight	D _{m6}	T10(A)	SKS93	54~58HRC	—
YEL03				Electroless Nickel Plating		
YEL11				9Cr18Mo		SUS440C
YEL21	D _{p6}	T10(A)	SKS93	54~58HRC	—	Electroless Nickel Plating
YEL23						

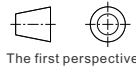
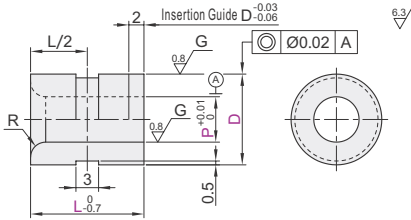

Part Number	Code	D Tol.		0.01 mm Inc.		0.1 mm Inc.		R
		D	m6	p6	P	L		
D _{m6}	8	+0.015	+0.024	4.00~4.50	10.0~15.0	1.0		
	10	+0.006	+0.015	4.00~6.50	10.0~22.0			
	12			6.00~8.50				
	15	+0.018	+0.029	8.00~10.50		2.0		
	18	+0.007	+0.018	10.00~12.50				
20			12.00~13.50	10.0~42.0				
D _{p6}	22	+0.021	+0.035	12.00~13.50		3.0		
	25	+0.008	+0.022	13.00~15.50				
	26			15.00~16.50				
	30			16.00~20.50	12.0~62.0			
	35	+0.025	+0.042	20.00~25.00				



Code Spec.

Set Screw Groove Depth

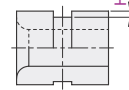

HA

Ordering Code HA

Changes the depth of set screw groove to depth 1.0 mm.

□ D<18 not applicable.



Part Number	Code	D	m6	p6	0.01 mm Inc.	0.1 mm Inc.
YEL01	8	+0.015	+0.024	4.00~6.50	10.0~22.0	
YEL03	12	+0.006	+0.015	6.00~8.50		

YEL01—D10—P4—L12

□ Optional Processing

Part Number	Code	D	m6	p6	0.01 mm Inc.	0.1 mm Inc.	Optional Processing Code
YEL01	8	+0.015	+0.024	4.00~6.50	10.0~22.0	HA	
YEL03	12	+0.006	+0.015	6.00~8.50			

YEL01—D10—P5—L15—HA



Discount price
Per 1~4 5~
Price 100% Additional quotation

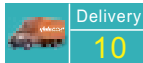

Delivery
10

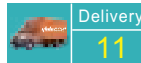

Delivery
11

□ Surface Free Treatment

□ Surface Finish

□ with Shoulder

Code	Type	Tolerance Grade	Material		Hardness	Surface Treatment	
			GB	Equiv.			
YEL41	with shoulder	D _{m6}	T10(A)	SKS93	54~58HRC	—	
YEL51			9Cr18Mo	SUS440C			48~53HRC
YEL61			D _{p6}	T10(A)			SKS93

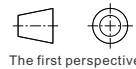
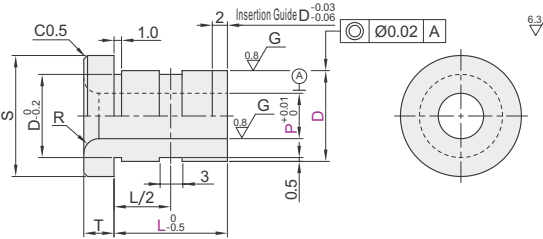

Part Number	Code	D Tol.		0.01 mm Inc.		0.1 mm Inc.		R	S	T
		D	m6	p6	P	L				
D _{m6}	8	+0.015	+0.024	4.00~4.50	8.0~12.0	1.0			12	3
	10	+0.006	+0.015	4.00~6.50	8.0~17.0				14	
	12			6.00~8.50					16	
	15	+0.018	+0.029	8.00~10.50		19			4	
	18	+0.007	+0.018	10.00~12.50		22				
D _{p6}	20			12.00~13.50	10.0~37.0	2.0			26	
	22			12.00~13.50						
	25	+0.021	+0.035	13.00~15.50						5
	26	+0.008	+0.022	15.00~16.50		30				
	30			16.00~20.50	12.0~52.0	35			6	
35	+0.025	+0.042	20.00~25.00		40					



Code Spec.

Set Screw Groove Depth

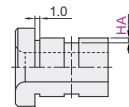

HA

Ordering Code HA

Changes the depth of set screw groove to depth 1.0 mm.

□ D<18 not applicable.



Part Number	Code	D	m6	p6	0.01 mm Inc.	0.1 mm Inc.
YEL41	8	+0.015	+0.024	4.00~6.50	8.0~17.0	
YEL51	12	+0.006	+0.015	6.00~8.50		

YEL41—D10—P5—L15

□ Optional Processing

Part Number	Code	D	m6	p6	0.01 mm Inc.	0.1 mm Inc.	Optional Processing Code
YEL41	8	+0.015	+0.024	4.00~6.50	8.0~17.0	HA	
YEL51	12	+0.006	+0.015	6.00~8.50			

YEL41—D10—P5—L15—HA



Discount price
Per 1~9 10~
Price 100% Additional quotation



Delivery
10

Bushings for Locating Pins

- ◀ Oval Type
- ◀ Anti-Shedding Type, Notched

○ Oval Type

Code	Type	Tolerance Grade	Material		Hardness	Surface Treatment	
			GB	Equiv.			
YEP01	Oval Type	Shoulder	Dp6	9CrWMn	SKS3	54 ~ 58HRC	
YEP02							Electroless Nickel Plating
YEP21							—
YEP22	Compact Flanged	Dm6	Dg6	9CrWMn	SKS3	54 ~ 58HRC	
YEP41							Electroless Nickel Plating
YEP42							—
YEP44	Compact Flanged	Dg6					Electroless Nickel Plating



Shoulder YEP01/02/21/22

Compact Flanged YEP41/42

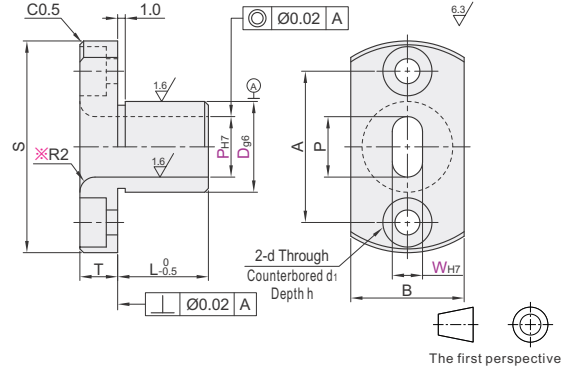
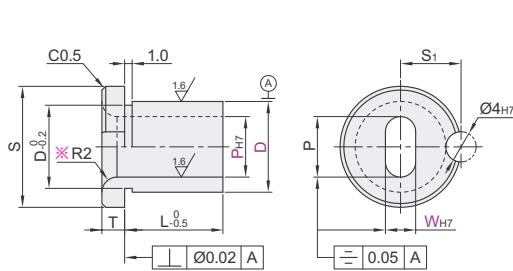

※ When wall is 2 mm or less and (D-P)/2 ≤ 2, R is 0.5.

The first perspective

Part Number	Code	D Tol.			0.01 mm Inc.		1 mm Inc.	Shoulder			Compact Flanged							
		D	p6	m6	g6	P	W	L	T	S	S ₁	T	S	A	B	d	d ₁	h
Dp6	YEP01	10	+0.024 -0.015	+0.015 +0.006	-0.005 -0.014	4.00~8.00			14	7		25	17	12		3.3	6.5	3.5
	YEP02	12	+0.029 +0.018	+0.018 +0.007	-0.006 -0.017	4.00~10.00			16	8	5	28	20	15				
Dm6	YEP21	20	+0.035 +0.022	+0.021 +0.008	-0.007 -0.020	10.00~18.00	3.00 ≤ W < P	8~42	20	10		36	26	22				
	YEP22	25				13.00~22.00		L+T ≤ P×3	26	13	6	40	30	25				
Dg6	YEP41	30	+0.042 +0.026	+0.025 +0.009	-0.009 -0.025	16.00~25.00			30	15		44	34	30				
	YEP42	35				18.00~25.00			35	17.5	8	56	42	35		6.6	11	6.5
									40	20		60	46	40				



Please order as shown

Part Number	Code	D	P	W	L
YEP01	D10	4~9	3.00	W<P	8~42
YEP02	12	4~10			

YEP01—D10—P8—W5—L25



Discount price	Per	1~9	10~
Price	100%	Additional quotation	



Delivery
11

○ Anti-Shedding Type, Notched

Code	Type	Material		Hardness	Accessories
		GB	Equiv.		
YEP61	Anti-Shedding Type Notched	T10(A)	SKS93	56~60HRC	Hex Socket Head Cap Screw 1 Pc.

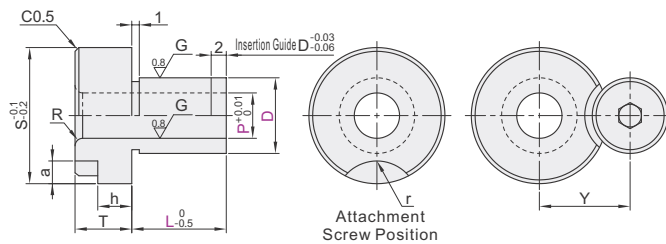

○ Attached Bolt

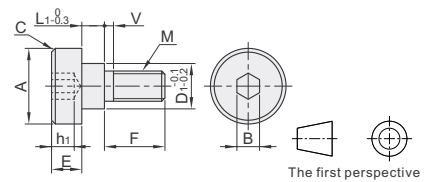

○ Included Screw

D ₁	L ₁	A	E	M	F	V	B	h ₁	C
6	3	10	4	4	8	1.2	3	3	0.5
8	4	12	4.5	5	10	1.4	4	3.5	0.5

Part Number	Code	Dg6	P		L		R	S	T	h	a	r	Bolt Position Y	Accessories Bolt
			0.01 mm Inc.	0.1 mm Inc.	0.01 mm Inc.	0.1 mm Inc.								
YEP61		10	-0.005 -0.014	4.00~6.50	3.0~15.0	1	18						12	
		12		4.00~6.50	10.0~20.0		20						13	
		15	-0.006 -0.017	6.00~8.50	10.0~32.0		23	7.5	3.0			5.5	14.5	M4
		18		8.00~10.50			26						16	
		20		10.00~12.50			28				3.0		18	
		22		12.00~13.50	12.0~37.0		30						19	
		25	-0.007 -0.020	13.00~15.50			33	9	4.0			7.0	20.5	M5
		26		15.00~16.50			34						21	
		30		16.00~25.00	12.0~52.0	3	38					23		



Please order as shown

Part Number	Code	Dg6	P	L
YEP61	10	4.0~6.5	3.0~15.0	
	12	4.0~6.5	10.0~20.0	

YEP61—D12—P6—L12



Discount price	Per	1~9	10~
Price	100%	Additional quotation	



Delivery
11

■ P Fixed

Code	Type	Material		Hardness	Surface Treatment
		GB	Equiv.		
YER01	Round Flange	9CrWMn	SKS3	Treated Hardness: 54~58HRC	—
YER02					Electroless Nickel Plating
YER21	Square Flange	9CrWMn	SKS3	54~58HRC	—
YER31	Compact Flange	9CrWMn	SKS3	54~58HRC	—
YER32					Electroless Nickel Plating



Inventory

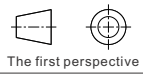
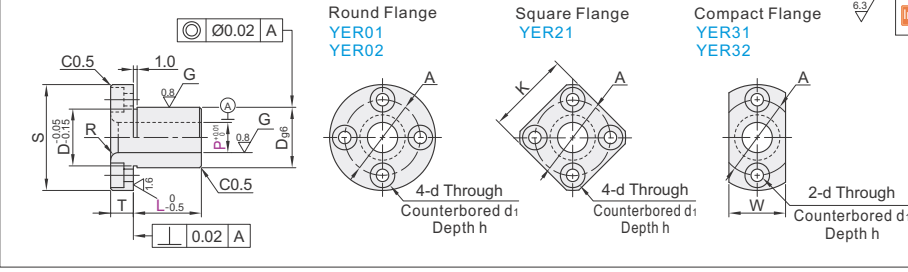

Part Number		L	R	S	K	W	T	D _{g6}	A	d	d ₁	h	
Code	P												
Round Flange	5	8 10 12 16	1	25	20	12	5	10	-0.005 -0.014	17	3.3	6.5	3.5
	6												
	8												
YER01	10	10 12 16 20	2	36	28	22	6	12	-0.006 -0.017	20	4.5	8	4.5
	YER02												
	12												
Square Flange	13	12 16 20 25 30	3	44	34	30	8	22	-0.007 -0.020	30	6.6	11	6.5
	YER21												
	15												
Compact Flange	16	16 20 25 30 35	3	56	44	35	8	25	-0.009 -0.025	42	6.6	11	6.5
	YER31												
	YER32												
	20												
	25												

■ P Configurable

Code	Type	Material	Hardness	Surface Treatment	
					GB
YER41	Round Flange	T10(A)	SKS93	Treated Hardness: 54~58HRC	—
YER42					Black Oxide
YER43					Electroless Nickel Plating
YER51	3-Point Stopper	T10(A)	SKS93	54~58HRC	—
YER61	Square Flange	T10(A)	SKS93	54~58HRC	—
YER71	Compact Flange	T10(A)	SKS93	54~58HRC	—
YER72					Black Oxide
YER73					Electroless Nickel Plating

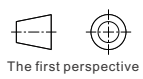
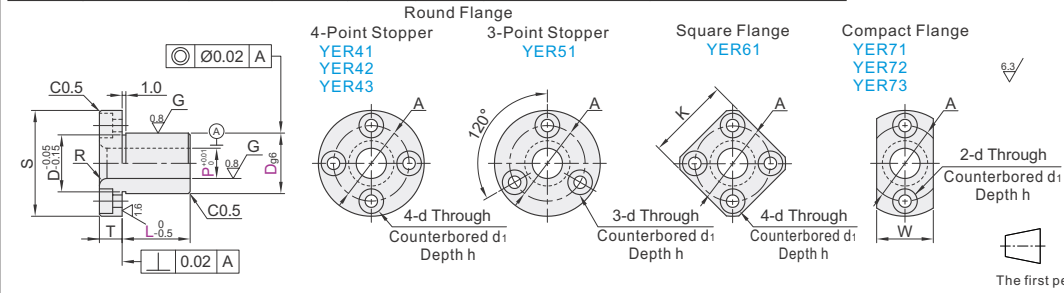

Part Number		D _{g6}	P	L	R	S	K	W	T	A	d	d ₁	h
Code	P												
Round Flange	10	-0.005 -0.014	4.00~6.50	5.0~17.0	1	25	20	12	5	17	3.3	6.5	3.5
	YER41												
	YER42												
	YER43												
Square Flange	18	-0.006 -0.017	8.00~10.50	10.0~37.0	2	36	28	22	6	20	4.5	8	4.5
	YER51												
	20												
Compact Flange	22	-0.007 -0.020	12.00~13.50	12.0~37.0	3	44	34	30	8	30	6.6	11	6.5
	YER61												
	25												
	26	-0.009 -0.025	15.00~16.50	12.0~52.0	3	56	44	35	8	42	6.6	11	6.5
	YER71												
	YER72												
	YER73												
	30												
	35												

① P configurable type must satisfy L+T ≤ P × 3.0.

■ P Fixed

Part Number	Code	P	L
YER01—P5—L10	YER01	5	10
YER02—P6—L12	YER02	6	12
YER21—P12—L16	YER21	12	16
YER31—P13—L12	YER31	13	12
YER32—P15—L15	YER32	15	15
YER31—P16—L20	YER31	16	20
YER32—P20—L25	YER32	20	25

■ P Configurable

Part Number	Code	D _{g6}	P	L
YER41—D10—P6—L6	YER41	10	6	6
YER42—D12—P8—L8	YER42	12	8	8
YER43—D18—P18—L18	YER43	18	18	18
YER51—D20—P20—L20	YER51	20	20	20
YER61—D22—P22—L22	YER61	22	22	22
YER71—D25—P25—L25	YER71	25	25	25
YER72—D26—P26—L26	YER72	26	26	26
YER73—D30—P30—L30	YER73	30	30	30



Discount price	Per	1~4	5~
Price	100%	Additional quotation	



Delivery	10
Surface Free Treatment	



Delivery	11
Surface Finish	

Bushings for Inspection Jigs

Oval Type • D-Cut with Shoulder

Code	Type		Material		Hardness
			GB	Equiv.	
YEQ31	Oval Type	D-Cut	T10(A)	SKS93	48~58HRC

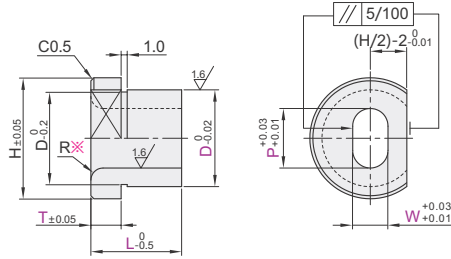

P/W	H7 Tol
3.00~6.00	+0.012 0
6.01~10.00	+0.015 0
10.01~18.00	+0.018 0
18.01~26.00	+0.021 0



※ When wall is 2 mm or less $(D-P)/2 \leq 2$, R is 0.5.

Part Number	0.01 mm Inc.		0.01 mm Inc.		1 mm Inc.		T	R	H
	Code	D	P	W	L				
YEQ31		8	4.00~6.00	P>W (W≥3)	10~20		2	2	D+4
		10	4.00~8.00						
		12	4.00~10.00						
		16	6.00~14.00						
		20	10.00~17.00						
	25	14.00~21.00			5				



Code	Spec.		Code	Spec.	
DF	Adds Groove for Adhesive 	[Ordering Code] DF □ D≥P+3: Applicable only when a wall of 1.5mm or thicker is remaining. □ Applicable when L≥15.	TD	Changes Shoulder Thickness Tolerance 	[Ordering Code] TD □ Changes shoulder thickness tolerance to ±0.01.
DE	Adds Groove for Retaining 	[Ordering Code] DE □ D≥P+3: Applicable only when a wall of 1.5mm or thicker is remaining. □ Applicable when L≥15.	LC	Changes L Dimension Tolerance 	[Ordering Code] LC □ Changes L dimension tolerance to $^{0}_{-0.05}$. □ Applicable only when L≤19.



Part Number	0.01 mm Inc.	0.01 mm Inc.	1 mm Inc.	T
YEQ31	D10	P6	W5	L10
	T2			

Optional Processing

Part Number	0.01 mm Inc.	0.01 mm Inc.	1 mm Inc.	T	Optional Processing Code
YEQ31	D10	P6	W5	L10	T2

Discount price
 Per 1~19 20~
 Price 100% Additional quotation

Delivery
 16

Loading Pins Bushings for Loading Pins A6

Bushings for Locating Pins

Standard (with Oil Grooves) with Shouldered

Code	Type		Material		Hardness	Surface Treatment
			GB	Equiv.		
YEY01	with Shouldered	Standard	GCr15	SUJ2	56HRC~	—



Inventory

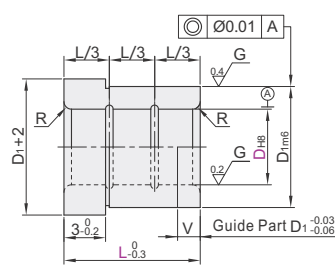

Part Number			L	D ₁		V	R
Code	D _{H8}						
YEY01	6	+0.018 0	8 10 12 16	12		2	0.5
	8	+0.022 0	8 10 12 16 20	14	+0.018 +0.007		1
	10			16		3	
	12			18			1.2
	13	+0.027 0	10 12 16 20 25	22			
	15			25	+0.021 +0.008		1.5
	16		16 20 25 30	26		4	
	20	+0.033 0		30			2.0
	25		20 25 30 35	35	+0.025 +0.009		



Please order as shown

Part Number			L
Code	D _{H8}		
YEY01	10	+0.022 0	8 10 12 16 20

YEY01 - D8 - L10



Discount price		
Per	1~29	30~
Price	100%	Additional quotation



Delivery	
	10

Code	Type	Tolerance Grade	Material		Hardness	Surface Treatment
			GB	Equiv.		
YFD01	Round	Dm6	9CrWMn	SKS3	Treated Hardness: 58-61HRC	—

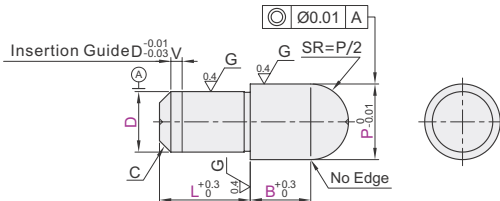

- ① SUS304 may be grinded and without center hole.
- ② With center hole, when the P size is small, the spherical surface is almost invisible.



型号 代码	D公差		最小单位0.01			C	V	(W)	
	D	m6	p6	P	L				B
YFD01	1			1.50~3.00	2~3	1.5~6.0	0.1	0	—
	2	+0.008 +0.002	+0.012 +0.006	2.50~6.00	2~8		0.5		1.2
	3			3.50~8.00	3~10				1.5
	4			4.50~8.00	4~15	1.5~15.0			1.8
	5	+0.012 +0.004	+0.020 +0.012	5.50~10.00	5~15		1		2.2
	6			6.50~12.00	5~15			1	3
	8	+0.015 +0.006	+0.024 +0.015	8.50~15.00	5~18	1.5~30.0	1.5		3.5
	10			11.00~17.00	5~22				4
	12			13.00~20.00	6~26	3.0~30.0	2		5
	13	+0.018 +0.007	+0.029 +0.018	14.00~20.00	7~28				5.5
	16			17.00~27.00	8~35	5.0~30.0	3	2	7
	20	+0.021 +0.008	+0.035 +0.022	22.00~30.00	10~42				9



Please order as shown

Part Number	D	P	L	B
Code	D	P	L	B
YFD01	2	6	8	5

YFD01—D2—P3—L6—B6

Optional Processing

Part Number	D	P	L	B	Optional Processing Code
Code	D	P	L	B	RC
YFD01	2	6	8	5	RC

YFD01—D2—P3—L6—B6—RC



Optional Processing

Code	Spec.
RC	<p>Changes the Relief to R0.5</p> <p>Ordering Code RC</p> <p>① P-D≤2 not applicable.</p>



Discount price	Per	1~19	20~
Price	100%	Additional quotation.	



Delivery
10

Locating Pins

with Tapped Shank Large Head Spherical

Code	Type	Material		Hardness	Surface Treatment
		GB	Equiv.		
YFF41	Round	9CrWMn	SKS3	Treated Hardness: 58-61HRC	—
YFF61	Diamond				



Self-made

Round
YFF41

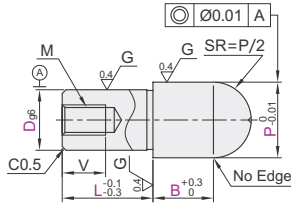

Diamond
YFF61

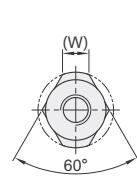
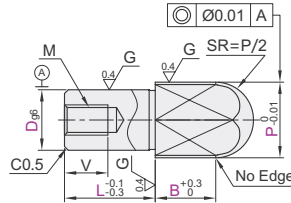

6.3/

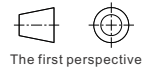

The first perspective

Round

Code	Part Number	D _{g6}	0.01 mm Inc.	1 mm Inc.	0.1 mm Inc.	M	V
			P	L	B		
YFF41	5		5.50~10.00	5~12		M2	3
	6	-0.004 -0.012	6.50~12.00	6~15	1.5~15.0	M3	5
	8T		8.50~15.00	8~18		M4	6
	8	-0.005 -0.014	8.50~15.00	8~18		M5	8
	10T		11.00~17.00	6~18		M4	6
	10		11.00~17.00	10~22		M5	8
	12T		13.00~18.00	8~20	3.0~30.0	M4	6
	12		13.00~18.00	12~26		M5	8
	13T	-0.006 -0.017	14.00~20.00	8~22		M6	9
	13		14.00~20.00	13~28		M8	10
	16T		17.00~27.00	10~26	5.0~30.0	M6	9
	16		17.00~27.00	16~35		M8	12
	20T	-0.007 -0.020	22.00~30.00	12~32		M6	9
	20		22.00~30.00	20~42		M8	12

Diamond

Code	Part Number	D _{g6}	0.01 mm Inc.	1 mm Inc.	0.1 mm Inc.	(W)	M	V
			P	L	B			
YFF61	5		5.50~10.00	9~12		2.2	M2	3
	6	-0.004 -0.012	6.50~12.00	9~15	1.5~15.0	3	M3	5
	8T		8.50~15.00	12~18			M4	6
	8	-0.005 -0.014	8.50~15.00	12~18		3.5	M5	8
	10T		11.00~17.00	12~18			M4	6
	10		11.00~17.00	12~22		4	M5	8
	12T		13.00~18.00	12~20	3.0~30.0		M4	6
	12		13.00~18.00	12~26		5	M5	8
	13T	-0.006 -0.017	14.00~20.00	14~22			M6	9
	13		14.00~20.00	14~28		5.5	M8	10
	16T		17.00~27.00	14~26	5.0~30.0		M6	9
	16		17.00~27.00	16~35		7	M8	12
	20T	-0.007 -0.020	22.00~30.00	18~32			M6	9
	20		22.00~30.00	20~42		9	M8	12

Locating Pins
Business for Locating Pins
A6



Part Number	Code	D _{g6}	P	L	B
YFF41	5		5.50-8.00	5-12	2.0-10.0
YFF41	6		6.50-10.00	6-15	2.0-12.0

YFF41—D6—P10—L10—B8

Optional Processing

Part Number	Code	D _{g6}	P	L	B	Optional Processing Code
YFF41	5		5.50-8.00	5-12	2.0-10.0	RC
YFF41	6		6.50-10.00	6-15	2.0-12.0	RC

YFF41—D6—P10—L10—B8—RC



Code	Spec.
RC	Changes the relief to R0.5
	Ordering Code RC
	P-D≤2 not applicable.



Per	Discount price
1~19	20~
Price	100% Additional quotation.

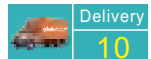

Code	Type	Material		Hardness	Surface Treatment
		GB	Equiv.		
YFL11	Round	9Cr18Mo	SUS440C	Treated Hardness: 48-53HRC	Buffed Surface
YFL26	Diamond				

□ Tolerance Selection

D or P	g6	h7	m6	p6	s
1.50~3.00	-0.002 -0.006	0 -0.010	+0.008 +0.002	+0.012 +0.006	
3.01~6.00	-0.004 -0.012	0 -0.012	+0.012 +0.004	+0.020 +0.012	
6.01~10.00	-0.005 -0.014	0 -0.015	+0.015 +0.006	+0.024 +0.015	0 -0.01
10.01~18.00	-0.006 -0.017	0 -0.018	+0.018 +0.007	+0.029 +0.018	
18.01~30.00	-0.007 -0.020	0 -0.021	+0.021 +0.008	+0.035 +0.022	

Round YFL11

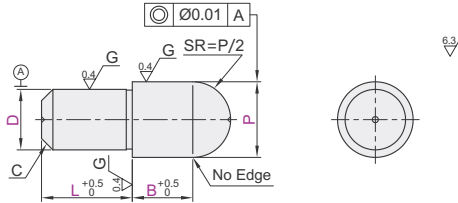

Self-made

□ When D=P, Round Shape has no relief, and there are two forms:

When D=P and tolerances are different

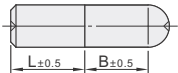

When D=P and tolerances are the same



When D = P, Diamond-shape end has a relief

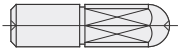

Diamond YFL26

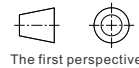
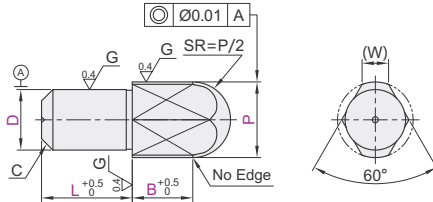

□ SUS440C Stainless Steel has an identification groove on D part.

Code	Part Number		D	0.01 mm Inc.		1 mm Inc.		0.1 mm Inc.		C	(W)
	D Tol.	P Tol.		P	L	B					
Round YFL11	m6	s	2	2.00~4.00	2~8				0.5	1.2	
			3	3.00~6.00	3~8				1.5		
			4	4.00~7.00	4~10	2.0~10.0			1.8		
			5	5.00~8.00	5~12				2.2		
			6	6.00~10.00	6~15	2.0~12.0			3		
Diamond YFL26	g6	p6	8	8.00~13.00	8~18	2.0~15.0		1.5	3.5		
			10	10.00~15.00	10~22	3.0~20.0		4			
			12	12.00~16.00	12~26			2	5		
			13	13.00~18.00	13~28				5.5		
			16	16.00~25.00	16~35	5.0~20.0		3	7		
	h7	h7	20	20.00~30.00	20~42				9		



Please order as shown

Code	Part Number		D	0.01 mm Inc.		1 mm Inc.		0.1 mm Inc.	
	D Tol.	P Tol.		P	L	B			
YFL11	m6	s	8	8.00~13.00	8~18	2.0~15.0			
YFL26	h7	g6	10	10.00~15.00	10~22	3.0~20.0			

YFL11 - h7 - g6 - D10 - P13 - L5 - B4.3



Discount price		
Per	1~18	19~
Price	100%	Additional quotation

□ Optional Processing

Code	Part Number		D	0.01 mm Inc.		1 mm Inc.		0.1 mm Inc.		Optional Processing Code
	D Tol.	P Tol.		P	L	B				
YFL11	m6	s	8	8.00~13.00	8~18	2.0~15.0			RC DB DC	
YFL26	h7	g6	10	10.00~15.00	10~22	3.0~20.0				

YFL11 - h7 - g6 - D10 - P13 - L5 - B4.3 - RC



Delivery
11



Optional Processing

Code	Spec.		Code	Spec.							
RC	Changes the Relief to R0.5	Ordering Code RC □ P-D ≤ 2 not applicable.									
DB	Adds Insertion Guide	Ordering Code DB <table border="1"> <thead> <tr> <th>D</th> <th>V</th> </tr> </thead> <tbody> <tr> <td>3~12</td> <td>1</td> </tr> <tr> <td>13~20</td> <td>2</td> </tr> </tbody> </table>	D	V	3~12	1	13~20	2	DC	Adds an Air Vent	Ordering Code DC
D	V										
3~12	1										
13~20	2										

with Tapped Shank ▶ Small Head Spherical

Locating Pins

Code	Type	Material		Hardness	Surface Treatment
		GB	Equiv.		
YFR41	Round	9CrWMn	SKS3	Treated Hardness: 58-61HRC	—
YFR61	Diamond				

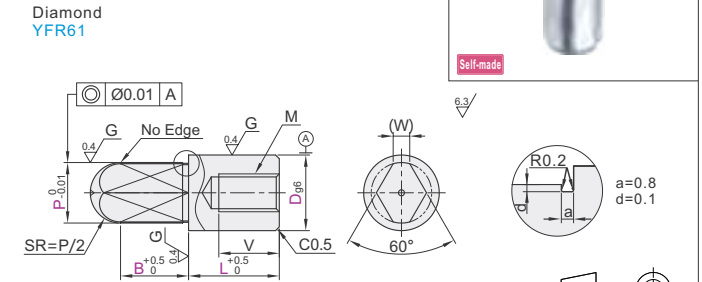
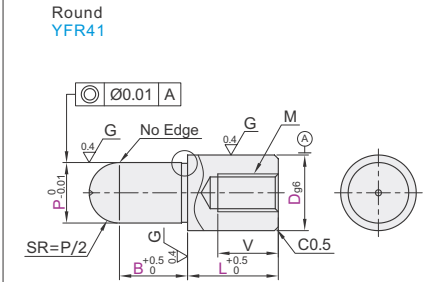
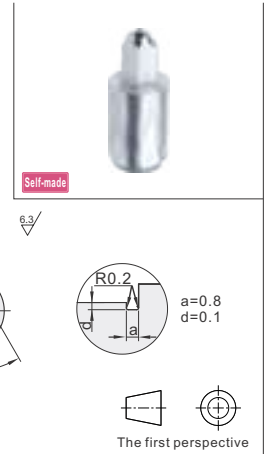

Round

Code	Part Number	D _{g6}	0.01 mm Inc.	1 mm Inc.	0.1 mm Inc.	M	V
			P	L	B		
YFR41	5	-0.004	3.00~5.00	8~12	2.0~10.0	M2	3
	6	-0.012	4.00~6.00	8~15	2.0~12.0	M3	5
	8T		6.00~8.00	11~18	2.0~15.0	M4	6
	8	-0.005				M5	8
	10T	-0.014		8~18		M4	6
	10		7.00~10.00	11~22		M5	8
	12T			8~20	3.0~20.0	M4	6
	12		7.00~12.00	12~26		M5	8
	13T			10~22		M6	9
	13	-0.006	8.00~13.00	13~28		M8	10
	16T	-0.017		10~26		M6	9
	16		10.00~16.00	16~35	5.0~20.0	M8	12
	20T	-0.007		12~32		M6	9
	20	-0.020	13.00~20.00	20~42		M8	12

Diamond

Code	Part Number	D _{g6}	0.01 mm Inc.	1 mm Inc.	0.1 mm Inc.	M	V	(W)
			P	L	B			
YFR61	5	-0.004	3.00~5.00	8~12	2.0~10.0	M2	3	1.2
	6	-0.012	4.00~6.00	9~15	2.0~12.0	M3	5	1.5
	8T		6.00~8.00	12~18	2.0~15.0	M4	6	1.8
	8	-0.005				M5	8	
	10T	-0.014		12~18		M4	6	2.2
	10		7.00~10.00	12~22		M5	8	
	12T			12~20	3.0~20.0	M4	6	
	12		7.00~12.00	12~26		M5	8	2.5
	13T			14~22		M6	9	
	13	-0.006	8.00~13.00	14~28		M8	10	3
	16T	-0.017		14~26		M6	9	
	16		10.00~16.00	16~35	5.0~20.0	M8	12	4
	20T	-0.007		18~32		M6	9	
	20	-0.020	13.00~20.00	20~42		M8	12	5



Part Number	P	L	B
Code D			
YFR41	5 3.00~5.00	8~12	2.0~10.0
	6 4.00~6.00	8~15	2.0~12.0

YFR41 — D6 — P6 — L10 — B5

Optional Processing

Part Number	P	L	B	Optional Processing Code
Code D				
YFR41	5 3.00~5.00	8~12	2.0~10.0	RC
	6 4.00~6.00	8~15	2.0~12.0	

YFR41 — D6 — P6 — L10 — B5 — RC



Per	1~19	20~
Price	100%	Additional quotation



Delivery
10



Code	Spec.
RC	Changes the Relief to R0.5
	Ordering Code RC
	Ⓜ P-D ≤ 2 not applicable.

with Tapped Shank ▶ Large Flat Head

Locating Pins

Code	Type	Material		Hardness	Surface Treatment
		GB	Equiv.		
YGF41	with Tapped Shank	9CrWMn	SKS3	Treated Hardness: 58-61HRC	—



Self-made

□ P Tol.

P	h6
5.50~6.00	0 -0.008
6.01~10.00	0 -0.009
10.01~18.00	0 -0.011
18.01~30.00	0 -0.013

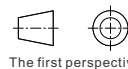
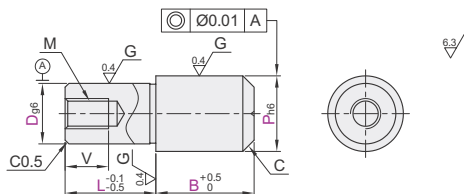

The first perspective

Code	Part Number	D _{g6}	0.01 mm Inc.			M	V	C
			P	L	B			
YGF41	5	-0.004 -0.012	5.50~8.00	5~12	2.0~10.0	M2	3	1.0
	6		6.50~10.00	6~15	2.0~12.0	M3	5	
	8T		9.00~13.00	6~18	2.0~15.0	M4	6	
	8	-0.005 -0.014		8~18		M5	8	1.5
	10T		11.00~15.00	6~18	3.0~20.0	M4	6	
	10			10~22		M5	8	2
	12T		13.00~16.00	12~26	3.0~30.0	M5	8	
	12			8~20		M4	6	3
	13T	-0.006 -0.017	14.00~18.00	8~22	5.0~30.0	M6	9	
	13			13~28		M8	10	
	16T		17.00~25.00	10~26	5.0~35.0	M6	9	3
	16			16~35		M8	12	
	20T	-0.007 -0.020	22.00~30.00	12~32	5.0~40.0	M6	9	
	20			20~42		M8	12	



Please order as shown

Part Number	D	P	L	B
YGF41	5	5.50~8.00	5~12	2~10
	6	6.50~10.00	6~15	2~12

YGF41—D6—P8—L8—B6

□ Optional Processing

Part Number	D	P	L	B	Optional Processing Code
YGF41	5	5.50~8.00	5~12	2~10	MA RC CN
	6	6.50~10.00	6~15	2~12	

YGF41—D6—P8—L8—B6—CN



Discount price	Per	1~19	20~
Price	100%		Additional quotation



Optional Processing

Code	MA	RC	CN												
	Adds tapped hole	Changes the relief to R0.5	Changes C Chamfering												
Spec.	Ordering Code MA <table border="1"> <thead> <tr> <th>D</th> <th>MA</th> <th>V₁</th> </tr> </thead> <tbody> <tr> <td>12</td> <td>M4</td> <td>6</td> </tr> <tr> <td>16</td> <td>M6</td> <td>9</td> </tr> <tr> <td>20</td> <td></td> <td></td> </tr> </tbody> </table>	D	MA	V ₁	12	M4	6	16	M6	9	20			Ordering Code RC □ P-D≤2 not applicable.	Ordering Code CN Changes C Chamfering at P dimension part to 0.5 or less. □ Not applicable to D dimension part.
D	MA	V ₁													
12	M4	6													
16	M6	9													
20															

Locating Pins

Tolerance Selectable · Standard Large Flat Head

Code	Type	Material		Hardness	Surface Treatment
		GB	Equiv.		
YGL02	Standard	9CrWMn	SKS3	Treated Hardness:58-61HRC, Plating Hardness:850HV~	Hard Chrome Plating, Plating Thickness: 3~5 μm



Tolerance Selection

D or P	g6	h7	m6	p6	s
1.50~3.00	-0.002 -0.008	0 -0.010	+0.008 +0.002	+0.012 +0.006	
3.01~6.00	-0.004 -0.012	0 -0.012	+0.012 +0.004	+0.020 +0.012	
6.01~10.00	-0.005 -0.014	0 -0.015	+0.015 +0.006	+0.024 +0.015	0 -0.01
10.01~18.00	-0.006 -0.017	0 -0.018	+0.018 +0.007	+0.029 +0.018	
18.01~30.00	-0.007 -0.020	0 -0.021	+0.021 +0.008	+0.035 +0.022	

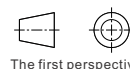
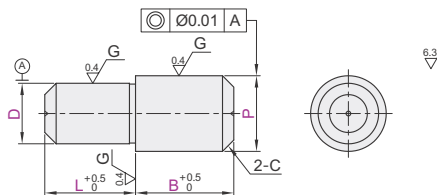

Part Number			0.01 mm Inc.	1 mm Inc.	0.1 mm Inc.	C	
Code	D Tol.	P Tol.	D	P	L		B
YGL02	m6 p6 g6 h7	s m6 p6 g6 h7	2	2.50~4.00	2~8		0.5
			3	3.50~6.00	3~8	2.0~10.0	
			4	4.50~7.00	4~10		
			5	5.50~8.00	5~12		1
			6	6.50~10.00	6~15	2.0~12.0	
			8	9.00~13.00	8~18	2.0~15.0	1.5
			10	11.00~15.00	10~22	3.0~20.0	
			12	13.00~16.00	12~26	3.0~30.0	2
			13	14.00~18.00	13~28	5.0~30.0	
			16	17.00~25.00	16~35	5.0~35.0	
20	22.00~30.00	20~42	5.0~40.0	3			



Part Number		0.01 mm Inc.	1 mm Inc.	0.1 mm Inc.		
Code	D Tol.	P Tol.	D	P	L	B
YGL02	m6	s	5	5.50~8.00	5~12	2.0~10.0
	p6	m6	6	6.50~10.00	6~15	2.0~12.0

YGL02—m6—s—D6—P7.5—L10—B8

Optional Processing

Part Number		0.01 mm Inc.	1 mm Inc.	0.1 mm Inc.	Optional Processing Code		
Code	D Tol.	P Tol.	D	P	L	B	
YGL02	m6	s	5	5.50~8.00	5~12	2.0~10.0	RC DB DC
	p6	m6	6	6.50~10.00	6~15	2.0~12.0	CN RC DB DC

YGL02—m6—s—D6—P7.5—L10—B8—CN



Per	1~19	20~
Price	100%	Additional quotation.

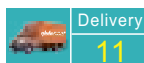

Code	Spec.
DC	Adds an Air Vent Ordering Code DC

Code	Spec.
RC	Changes the Relief to R0.5 Ordering Code RC P-D ≤ 2 not applicable.

Code	Spec.						
DB	Adds Insertion Guide Ordering Code DB <table border="1"> <tr> <th>D</th> <th>V</th> </tr> <tr> <td>3~12</td> <td>1</td> </tr> <tr> <td>13~20</td> <td>2</td> </tr> </table>	D	V	3~12	1	13~20	2
D	V						
3~12	1						
13~20	2						

Code	Spec.
CN	Changes C Chamfering Ordering Code CN Changes C Chamfering at P dimension part to 0.5 or less. When D ≤ 3, not applicable. Not applicable to D dimension part.

Locating Pins

Standard/Tapped Straight, Spherical Tip / Tapered Tip

Spherical Tip		Tapered Tip		Material		Hardness	Surface Treatment
Standard	Tapped	Standard	Tapped	GB	Equiv.		
YHD01	YHD41	YHE01	YHE41	9CrWMn	SKS3	Treated Hardness:58-61HRC	—
YHD02	YHD42	YHE02				Treated Hardness:58-61HRC, Plating Hardness:850HV~	Hard Chrome Plating, Plating Thickness: 3-5 μm
YHD03	—	YHE03				—	—
YHD11	YHD51	YHE11	—	0Cr18Ni9	SUS304	Plating Hardness:850HV~	Hard Chrome Plating, Plating Thickness: 3-5 μm
—	—	YHE12					
YHD21	YHD61	YHE21		9Cr18Mo	SUS440C	Treated Hardness:48-53HRC	—



Self-made

Spherical Tip · Standard
YHD01/02/03/11/21

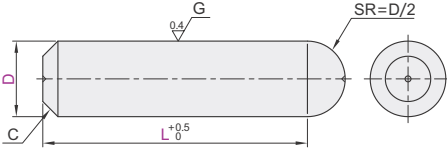

Spherical Tip · Tapped
YHD41/42/51/61

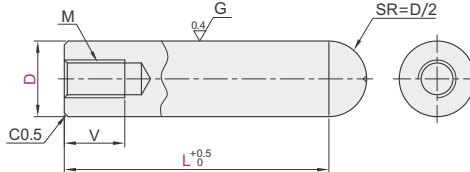

Tolerance Selection

D	M	P	G	H
	m6	p6	g6	h7
1~3	+0.008 +0.002	+0.012 +0.006	-0.002 -0.008	0 -0.010
4~6	+0.012 +0.004	+0.020 +0.012	-0.004 -0.012	0 -0.012
8-10	+0.015 +0.006	+0.024 +0.015	-0.005 -0.014	0 -0.015

Tapered Tip · Standard
YHE01/02/03/11/12/21

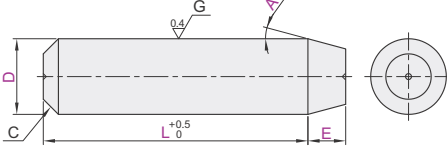

Tapered Tip · Tapped
YHE41

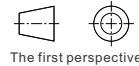
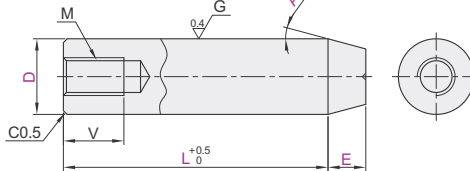

The first perspective

① SUS440C Stainless Steel has an identification groove on D part.

Spherical Tip, Standard

Part Number		L		C
Code	D Tol.	D	0.1 mm Inc.	
YHD01 YHD02 YHD03 YHD11 YHD21	M(m6)	1	3.0~12.0	0.1
		2		0.5
	P(p6)	3	3.0~22.0	
		4		
	G(g6)	5	5.0~32.0	1
		6		
	H(h7)	8		1.5
		10	5.0~42.0	2

Spherical Tip, Tapped

Part Number		L		M	V
Code	D Tol.	D	0.1 mm Inc.		
YHD41 YHD51 YHD42 YHD61	M(m6)	5		M2	3
		6	10.0~32.0	M3	5
	P(p6)	8		M5	8
		10	15.0~42.0	M5	8

Tapered Tip, Standard

Part Number		L	E	A	C
Code	D Tol.	D	0.1 mm Inc.	0.1 mm Inc.	Selection
YHE01 YHE11 YHE02 YHE12 YHE03 YHE21	M(m6)	1	3.0~12.0	0.2~1.5	15
		2		0.5~3.5	30
	P(p6)	3	3.0~22.0	0.5~5.5	45
		4		0.5~7.0	60
	G(g6)	5	5.0~32.0	0.5~9.0	1
		6			
	H(h7)	8		0.5~10.0	2
		10	5.0~42.0		

① D, E, A parameters need to meet $0 < D-2E \tan A < D$.

Tapered Tip, Tapped

Part Number		L	E	A	M	V
Code	D Tol.	D	0.1 mm Inc.	0.1 mm Inc.	Selection	
YHE41	M(m6)	5	0.5~9.0	15	M2	3
		6	10.0~32.0	30	M3	5
	P(p6)	8	15.0~42.0	45	M5	8
		10		60	M5	8

① D, E, A parameters need to meet $0 < D-2E \tan A < D$.

Spherical Tip, Standard

Part Number		L	C
Code	D Tol.	D	0.1 mm Inc.
YHD01	M(m6)	1	3.0~12.0
YHD02	P(p6)	2	3.0~22.0

YHD01—M—D2—L12



Please order as shown

Tapered Tip, Standard

Part Number		L	E	A
Code	D Tol.	D	0.1 mm Inc.	0.1 mm Inc.
YHE01	M(m6)	1	3.0~12.0	15
YHE02	P(p6)	2	3.0~22.0	30

YHE01—M—D2—L10—E2—A15

Optional Processing

Part Number		L	E	A	Optional Processing Code
Code	D Tol.	D	0.1 mm Inc.	0.1 mm Inc.	
YHE01	M(m6)	1	3.0~12.0	15	DB
YHE02	P(p6)	2	3.0~22.0	30	DB

YHE01—M—D2—L10—E2—A15—DC



Optional Processing

Code	Spec.																								
DB	<p>Adds Insertion Guide</p> <p>Guide Part D^{-0.01}_{-0.03}</p> <p>① Not applicable to D ≤ 2.</p>																								
DC	<p>Adds an Air Vent</p> <p>D-0.15</p> <p>① Ordering Code DC</p>																								
MA	<p>Adds a Tapped Hole</p> <p>① Ordering Code MA</p> <table border="1"> <thead> <tr> <th>D</th> <th>MA</th> <th>E1</th> </tr> </thead> <tbody> <tr> <td>6</td> <td>M3</td> <td>4</td> </tr> <tr> <td>8-10</td> <td>M4</td> <td>6</td> </tr> </tbody> </table> <p>① Applicable when D ≥ 6. ② Only applicable to Tapered Tip, Standard.</p>	D	MA	E1	6	M3	4	8-10	M4	6															
D	MA	E1																							
6	M3	4																							
8-10	M4	6																							
DM DP DG DH	<p>Changes Outer Diameter Tolerance</p> <p>① Ordering Code DM10</p> <p>Changes outer diameter tolerance by L1 distance.</p> <table border="1"> <thead> <tr> <th rowspan="2">D</th> <th colspan="4">Tolerance Code</th> </tr> <tr> <th>DM</th> <th>DP</th> <th>DG</th> <th>DH</th> </tr> </thead> <tbody> <tr> <td>1~3</td> <td>+0.008 +0.002</td> <td>+0.012 +0.006</td> <td>-0.002 -0.008</td> <td>0 -0.010</td> </tr> <tr> <td>4~6</td> <td>+0.012 +0.004</td> <td>+0.020 +0.012</td> <td>-0.004 -0.012</td> <td>0 -0.012</td> </tr> <tr> <td>8-10</td> <td>+0.015 +0.006</td> <td>+0.024 +0.015</td> <td>-0.005 -0.014</td> <td>0 -0.015</td> </tr> </tbody> </table> <p>① In selection, L1 Dimensions must be changed to DM (DP / DG / DH).</p>	D	Tolerance Code				DM	DP	DG	DH	1~3	+0.008 +0.002	+0.012 +0.006	-0.002 -0.008	0 -0.010	4~6	+0.012 +0.004	+0.020 +0.012	-0.004 -0.012	0 -0.012	8-10	+0.015 +0.006	+0.024 +0.015	-0.005 -0.014	0 -0.015
D	Tolerance Code																								
	DM	DP	DG	DH																					
1~3	+0.008 +0.002	+0.012 +0.006	-0.002 -0.008	0 -0.010																					
4~6	+0.012 +0.004	+0.020 +0.012	-0.004 -0.012	0 -0.012																					
8-10	+0.015 +0.006	+0.024 +0.015	-0.005 -0.014	0 -0.015																					



Discount price
Per 1~19 20~
Price 100% Additional quotation



Delivery
8

① Surface Free Treatment/No Hardness



Delivery
10

① Surface Free Treatment



Delivery
11

① Surface Finish

Code	Type	Shape	Material		Hardness	Surface Treatment
			GB	Equiv.		
YHF01	Tolerance Fixed	Flat	9CrWMn	SKS3	Treated Hardness:48-56HRC	—
YHF05			0Cr18Ni9	SUS304		
YHF08			9Cr18Mo	SUS440C		



Self-made

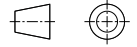
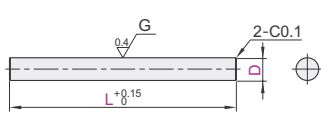

The first perspective

Part Number		D Tol.	0.5 mm Inc.
Code	0.1 mm Inc. D		L
YHF01	1.0~2.0	0 -0.005	3.0~32.0
YHF05	2.1~3.0		
YHF08			



Optional Processing

Code	Spec.
CN	Changes C Chamfering  Ordering Code CN D dimension C chamfering 0.1 is changed to 0.3. ① Applicable when D ≥ 1.5. ② Combination of CN and DB is not available.

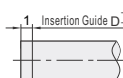
Code	Spec.
DB	Adds Insertion Guide  Ordering Code DB ① Applicable when D ≥ 2.1 and L ≥ 5.0 ② Combination of CN and DB is not available.



Please order as shown

Part Number	0.5 mm Inc.	
	D	L
YHF01	1.0~2.0	3.0~32.0
YHF05	2.1~3.0	3.0~32.0

YHF05 — D2.5 — L15

Optional Processing

Part Number	0.5 mm Inc.		Optional Processing Code
	D	L	
YHF01	1.0~2.0	3.0~32.0	DB CN
YHF05	2.1~3.0	3.0~32.0	DB CN

YHF05 — D2 — L30 — CN



Discount price		
Per	1~9	10~
Price	100%	Additional quotation

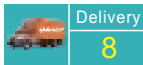

① SurfaceFree Treatment No Hardness



① SurfaceFree Treatment With Hardness

Locating Pins

Standard Large Head, Selectable Pilot Shape

Code	Type	Tolerance Grade	Material		Hardness	Surface Treatment
			GB	Equiv.		
YHP31	Diamond	Dm6	0Cr18Ni9	SUS304	—	—

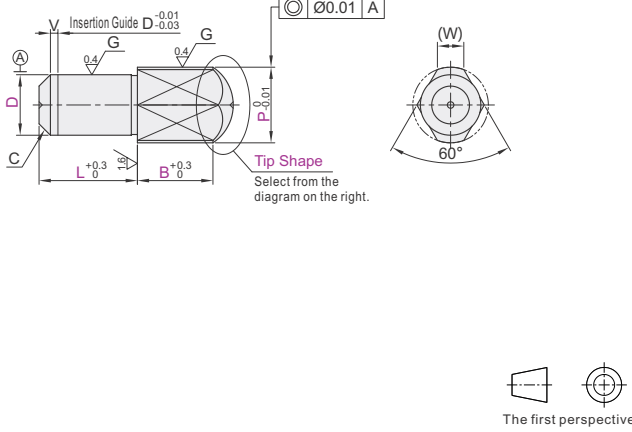

Tip Shape	
A	
B	
C	

Part Number		D Tol.	0.1 mm Inc.		R 1 mm Inc.	G 1 mm Inc.	1 mm Inc.	C	V	(W)	
Code	Tip Shape		D	P	B	A Shape only, C Shape	B Shape only				L
YHP31	A	2	+0.008 +0.002	2.50~6.00	2.0~10.0	Shape A R ≥ P/2		2~8	0.5	0	1.2
		3		3.50~8.00				3~12		1.5	
		4		4.50~9.00				4~15		1.8	
	B	5	+0.012 +0.004		5.50~10.00	2.0~10.0	G ≤ P	5~15	1.5	1	2.2
		6			6.50~12.00	2.0~12.0		5~15		1	3
		8			9.00~15.00	2.0~15.0		5~18		3.5	
	C	10	+0.015 +0.006		11.00~20.00	3.0~20.0	Shape C R ≤ P/2	5~22	2	1.5	4
		12			13.00~20.00			6~26		7	
		16	+0.018 +0.007		17.00~27.00			8~35		2	5
		20	+0.021 +0.008		21.00~30.00	5.0~20.0		10~42		3	2



Part Number		0.1 mm Inc.		G 1 mm Inc.	1 mm Inc.
Code	Tip Shape	D	P	B	B Shape only
YHP31	A	10	11.00~20.00		5~22
YHP31	B	12	13.00~20.00	3.0~20.0	6~26

YHP31 - B - D12 - P15 - B20 - G10 - L18



Discount price	
Per	Price
1~19	100%
20~	Additional quotation



Delivery	
8	

Part Number		0.1 mm Inc.		R	1 mm Inc.
Code	Tip Shape	D	P	B	L
YHP31	A	10	11.00~20.00		5~22
YHP31	B	12	13.00~20.00	3.0~20.0	6~26

YHP31 - A - D12 - P15 - B20 - R10 - L18

Locating Pins

with Shoulder, Short Set Screw, Circumference Groove Shape for Ordinary Fixtures, Tip Shape Selectable

Code	Type	Shape	Material		Hardness	Surface Treatment
			GB	Equiv.		
YKC02	Short Set Screw	Circumference Groove Shape	Round	35CrMo SCM435	Treated Hardness:33~38HRC, Plating Hardness:850HV~	Hard Chrome Plating , Plating Thickness: 3~5 μm

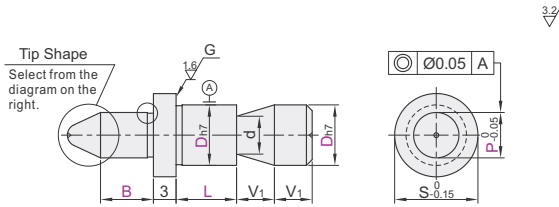
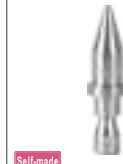

Surface Finish Relief

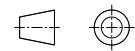
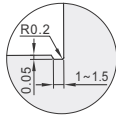

The first perspective

Tip Shape	
—	Taper R (Angle 30°) ① $e = P/2 + \tan(A/2) + R - [R + \sin(A/2)]$
B	Tapered ① The center hole remains. ② $P - 2E \tan(A/2) \geq 0.73$
R	Angle Selectable (Taper R) ① The center hole remains. ② $e = P/2 + \tan(A/2) + R - [R + \sin(A/2)]$

Code	Part Number	Tip Shape	Dh7	0.1 mm Inc.	1 mm Inc.	1 mm Inc.	A	1 mm Inc.	S	R	V1	d	Applicable Set Screw
				P	B	L		E(Shape B)					
YKC02	(Standard) Not Specified (Tip Shape Selectable)	B	6	3.0~7.0	5~32 (B≤P×4)	5~12	30 60 90 120	1~12	9	1	6	4	M5
		8	3.0~9.0	11					1.5	5			
		10	4.5~12.0	13					2	7			
		12	9.0~13.0	15					3	9			
		R	16	13.0~16.0				19	4		8	13	M6

Code	Spec.												
HC	Flat Machining Ordering Code HC ① H-P≥2												
TC	Adds Wrench Flats Ordering Code TC <table border="1"> <tr><th>S</th><th>S1</th></tr> <tr><td>9</td><td>7</td></tr> <tr><td>11</td><td>8</td></tr> <tr><td>13</td><td>11</td></tr> <tr><td>15</td><td>13</td></tr> <tr><td>19</td><td>17</td></tr> </table>	S	S1	9	7	11	8	13	11	15	13	19	17
S	S1												
9	7												
11	8												
13	11												
15	13												
19	17												

Code	Spec.
RB	Changes the Relief to Radius R Ordering Code RB1 ① Changes the relief to the following radius R, R(Selection):R1, R2, R3.

Code	Part Number	Tip Shape	Dh7	P	B	L	A	1 mm Inc.
YKC02	B	B	6	3~9	5~32	5~12	30	1~12
	R	R	8	3~9	5~32	5~12	60	1~12

YKC02—B—D6—P6—B20—L10—A30—E6

Optional Processing

Code	Part Number	Tip Shape	Dh7	P	B	L	A	1 mm Inc.	Optional processing Code
YKC02	B	B	6	3~9	5~32	5~12	30	1~12	HC TC RB
	R	R	8	3~9	5~32	5~12	60	1~12	

YKC02—B—D6—P6—B20—L10—A30—E6—HC



Discount price
Per 1~19 20~
Price 100% Additional quotation



Delivery
11

No Shoulder, Threaded Type ▶ for Fixtures, Taper R

Locating Pins

Code	Type		Shape	Material		Hardness	Surface Treatment
				GB	Equiv.		
YKP11	No Shoulder	Threaded Type	Round	35CrMo	SCM435	Treated Hardness:33~38HRC, Plating Hardness:850HV~	Hard Chrome Plating , Plating Thickness: 3~5 μm



Self-made

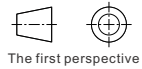
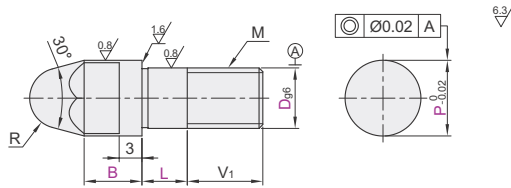

The first perspective

Code	Part Number		0.1 mm Inc.		1 mm Inc.	V ₁	R	M
	D _{g6}	P	B	L				
YKP11	3	-0.002 -0.008	4.0~6.0	2.0~16.0	5~12	5	2	M3
	4	-0.004 -0.012	5.0~8.0	2.0~20.0		6	3	M4
	5		6.0~10.0	2.0~24.0		8	4	M5
	6	-0.005 -0.014	8.0~12.0	2.0~24.0	8~17	10	4	M6
	8		10.0~16.0	2.0~26.0		12	6	M8
	10	-0.006 -0.017	12.0~20.0	3.0~35.0	10~20	15	6	M10
	12		14.0~25.0	3.0~35.0		18	8	M12
	16		18.0~32.0	5.0~35.0		22	8	M16
	20	-0.007 -0.020	22.0~35.0	5.0~35.0	15~22			M20



Optional Processing

Code	Spec.		Code	Spec.	
HC	Flat Machining 	Ordering Code HC	MD	Adds a Relief at the Thread End 	Ordering Code MD
AG()	Tip Angle Change 	Ordering Code AG60 Selection 60°, 90°, 120°.			



Please order as shown

Part Number	0.1 mm Inc.	1 mm Inc.
Code	D _{g6}	P B L
YKP11	3	4~5 2~16 3~12
	4	5~8 2~20 3~12

YKP11—D3—P5—B8—L8

Optional Processing

Part Number	0.1 mm Inc.	1 mm Inc.	Optional processing Code
Code	D _{g6}	P B L	
YKP11	3	4~5 2~16 3~12	HC AG()
	4	5~8 2~20 3~12	HC MD AG()

YKP11—D3—P5—B8—L8—AG60



Discount price
Per 1~19 20~
Price 100% Additional quotation

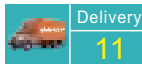

Delivery
11

L Selectable, Standard/Thin Wall Type

No Shoulder/with Shoulder

Bushings for Locating Pins

No Shoulder		with Shoulder		L Size	Tolerance Grade	Material		Treated Hardness	Surface Treatment	
Standard	Thin Wall	Standard	Thin Wall			GB	Equiv.			
YLJ01	YLJ41	YKY01	YKY41	Selection	Pp6	9CrWMn	SKS3	58HRC~	Electroless Nickel Plating	
YLJ02	—	YKY02	YKY42			9Cr18Mo	SUS440C			48~53HRC~
—	YLJ51	YKY11	—			9CrWMn	SKS3			58HRC~
YLJ21	YLJ61	YKY21	—	Selection	Pm6	9CrWMn	SKS3	58HRC~	Electroless Nickel Plating	
YLJ22	YLJ62	YKY22	YKY62			9Cr18Mo	SUS440C			48~53HRC~
YLJ31	YLJ71	YKY31	—			9CrWMn	SKS3			58HRC~



No Shoulder, Standard
YLJ01/02/21/22/31

No Shoulder, Thin wall Type
YLJ41/51/61/62/71

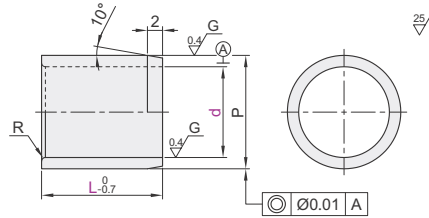
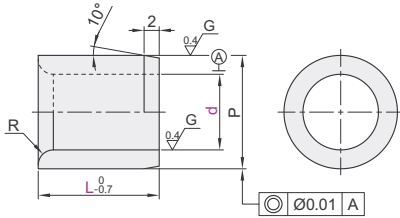

with Shoulder, Standard
YKY01/02/11/21/22/31

with shoulder, Thin wall Type
YKY41/42/62

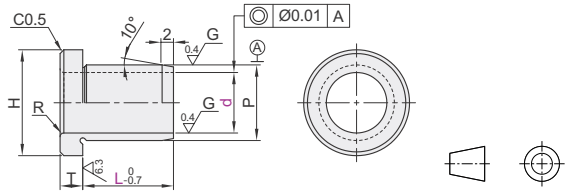
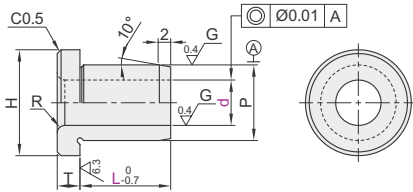

The first perspective

Standard

Part Number	Code	d	d Tol.		L	R	H	T	P	P Tol.		
			No Surface Treatment	Electroless Nickel Plating						p6	m6	
No Shoulder	with Shoulder	2	+0.008	+0.010	5 6 8 10 12	0.8	9	2.5	5	+0.020	+0.012	
		3	+0.002	0	0					7	+0.015	+0.006
	Pp6	Pp6	4	+0.012	+0.012	5 6 8 10 12 15 16 20	1.0	12	3	8	+0.024	+0.015
			5			0					10	+0.015
	YLJ01	YKY01	6	+0.014	+0.014	5 6 8 10 12 15 16 20 25	—	16	12	15	+0.029	+0.018
			8			+0.005					+0.005	6 8 10 12 15 16 20 25
	YLJ02	YKY02	10	+0.017	+0.017	8 10 12 15 16 20 25 30	2.0	22	18	22	+0.035	+0.021
			12			+0.006					+0.006	10 12 15 16 20 25 30
	Pm6	Pm6	13	+0.020	+0.020	10 12 15 16 20 25 30	—	30	5	25	+0.035	+0.021
			15			+0.006					+0.006	10 12 15 16 20 25 30
YLJ21	YKY21	16	+0.020	+0.020	10 12 15 16 20 25 30	3.0	35	6	30	+0.042	+0.025	
		20			+0.007					+0.007	12 15 16 20 25 30 35	40
YLJ31	YKY31	25	+0.007	+0.007	12 15 16 20 25 30 35	—	40	6	35	+0.042	+0.025	

Thin Wall Type

Part Number	Code	d	d Tol.		L	R	H	T	P	P Tol.		
			No Surface Treatment	Electroless Nickel Plating						p6	m6	
No Shoulder	with Shoulder	3	+0.008	+0.010	6 8 10 12	—	9	2.5	5	+0.020	+0.012	
		4	+0.002	0	0					6	+0.012	+0.004
	Pp6	Pp6	5	+0.012	+0.012	6 8 10 12 15 16	0.5	11	3	7	+0.024	+0.015
			6			0					8	+0.015
	YLJ41	YKY41	8	+0.014	+0.014	6 8 10 12 15 16 20	—	14	10	10	+0.024	+0.015
			YLJ51			YKY42					10	+0.005
	Pm6	Pm6	12	+0.017	+0.017	8 10 12 15 16 20	1.0	17	4	13	+0.029	+0.018
			13			+0.006					+0.006	10 12 15 16 20
	YLJ61	YKY62	15	+0.020	+0.020	10 12 15 16 20	2.0	21	5	17	+0.035	+0.021
			YLJ62			YLJ71					16	+0.007
Pm6	Pm6	20	+0.020	+0.020	10 12 15 16 20 25	—	26	5	19	+0.035	+0.021	
		25			+0.007					+0.007	10 12 15 16 20 25	26
YLJ71	—	25	+0.007	+0.007	16 20 25	2.0	31	6	26	+0.042	+0.025	
		—	—	—	—	—	36	6	31	+0.026	+0.009	



Standard

Part Number	Code	d	L
YKY01	2	5	6 8 10 12
YKY02	3	5	6 8 10 12
YKY01	d3	—	L8

Thin Wall Type

Part Number	Code	d	L
YKY41	3	6	8 10 12
YKY42	4	6	8 10 12 15 16
YKY41	d4	—	L12



Per	1~49	50~
Price	100%	Additional Quotation

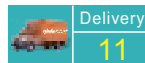

Surface free treatment

Surface finish

Bushings for Locating Pins

L Configurable, Standard/Thin wall Type No Shoulder/with Shoulder

No Shoulder		with Shoulder		L Size	Material		Hardness	Surface Treatment
Standard		Thin Wall Type			GB	Equiv.		
Dp6	Dm6	Dp6	Dm6					
YLL01	YLL21	—	—	Configurable	9CrWMn	SKS3	54~58HRC	—
—	—	YLF43	YLF63					



No Shoulder, Standard
YLL01
YLL21

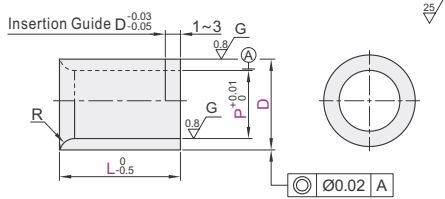

with Shoulder, Thin Wall Type
YLF43
YLF63

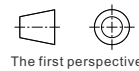
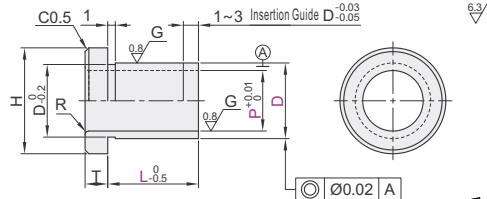

□ No Shoulder, Standard

Part Number Code	D Tol.			0.01 mm Inc.	0.1 mm Inc.	R		
	D	p6	m6					
Dp6 YLL01	5	+0.020 +0.012	-0.012 -0.004	2.00~2.50	5.0~8.0	0.8		
	7	+0.024 +0.015	+0.015 +0.006	2.00~3.50	5.0~10.0			
	8	+0.024 +0.015	+0.015 +0.006	3.00~4.50	5.0~15.0			
	Dm6 YLL21	10	+0.029 +0.018	+0.018 +0.007	4.00~6.50	5.0~22.0	1.0	
		12	+0.029 +0.018	+0.018 +0.007	6.00~8.50	5.0~22.0		
		15	+0.029 +0.018	+0.018 +0.007	8.00~10.50	5.0~22.0		
Dm6 YLL21		18	+0.035 +0.022	+0.021 +0.008	10.00~13.50	10.0~42.0	2.0	
		20	+0.035 +0.022	+0.021 +0.008	12.00~13.50	10.0~42.0		
		22	+0.035 +0.022	+0.021 +0.008	13.00~15.50	10.0~42.0		
		Dm6 YLL21	25	+0.042 +0.028	+0.025 +0.009	15.00~16.50	12.0~62.0	3.0
			26	+0.042 +0.028	+0.025 +0.009	16.00~20.50	12.0~62.0	
			30	+0.042 +0.028	+0.025 +0.009	16.00~20.50	12.0~62.0	

□ with Shoulder, Thin Wall Type

Part Number Code	D Tol.			0.01 mm Inc.	0.1 mm Inc.	R	H	T		
	D	p6	m6							
Dp6 YLL01	5	+0.020 +0.012	-0.012 -0.004	2.20~3.00	3.0~5.0	≤0.5	9	2.5		
	6	+0.012 +0.004	+0.012 +0.004	3.00~4.00	3.0~5.5		11			
	7	+0.024 +0.015	+0.015 +0.006	3.51~5.00	3.0~8.0		12			
	Dp6 YLF43	8	+0.024 +0.015	+0.015 +0.006	4.51~6.00	3.0~12.0	0.5	11		
		9	+0.024 +0.015	+0.015 +0.006	4.51~6.50	3.0~12.0		13.5	3	
		10	+0.024 +0.015	+0.015 +0.006	6.51~8.00	3.0~17.0		14		
Dm6 YLF63		11	+0.029 +0.018	+0.018 +0.007	8.00~9.00	3.0~17.0	1.0	15		
		12	+0.029 +0.018	+0.018 +0.007	8.51~9.00	3.0~17.0		16		
		13	+0.029 +0.018	+0.018 +0.007	8.51~10.00	3.0~17.0		17		
		Dm6 YLF63	14	+0.029 +0.018	+0.018 +0.007	9.00~11.00	10.0~37.0	1.0	18	4
			15	+0.029 +0.018	+0.018 +0.007	10.51~12.00	10.0~37.0		19	
			17	+0.029 +0.018	+0.018 +0.007	10.51~13.00	10.0~37.0		21	
	Dm6 YLF63		18	+0.035 +0.022	+0.021 +0.008	12.51~14.00	5.0~35.0	1.0	22	
			19	+0.035 +0.022	+0.021 +0.008	13.51~15.00	5.0~35.0		24	
			21	+0.035 +0.022	+0.021 +0.008	13.51~17.00	5.0~35.0		26	5
	Dm6 YLF63	22	+0.042 +0.028	+0.025 +0.009	15.51~19.00	10.0~37.0	1.5	30		
		25	+0.042 +0.028	+0.025 +0.009	15.51~19.00	10.0~37.0		35		
		26	+0.042 +0.028	+0.025 +0.009	16.51~20.00	10.0~37.0		36	6	
30		+0.042 +0.028	+0.025 +0.009	20.51~24.00	12.0~52.0	36		6		

① When P ≤ 3.59, L + T ≤ P × 2.5; When P ≥ 3.60, L + T ≤ P × 3.0.



Code	TD ()	DA	RE
Optional Processing	Change Shoulder Thickness	Adds an adhesive reservoir groove	Machines Radius R on both sides
Spec.	<p>Ordering Code TD4</p> <ul style="list-style-type: none"> ① 1 mm Inc. ② Applicable when D ≥ 12. ③ Only applicable to with shoulder types. 	<p>Ordering Code DA</p> <ul style="list-style-type: none"> ① When L ≤ 13, 2 oil grooves are processed. ② When L > 13, 3 oil grooves will be processed. ③ When D ≤ 13, D-P ≥ 3. When D ≥ 14, D-P ≥ 4. ④ Only applicable to standard types and L > 9 and above specifications. 	<p>Ordering Code RE</p> <ul style="list-style-type: none"> ① Applicable to Thickness 1.5 mm or more. ② Size of R will be the same as R on shoulder side with D dimension 10 or more.

□ with Shoulder-Thin wall Type

Part Number	0.01 mm Inc.		0.1 mm Inc.	
Code	D	P	L	L
YLF43	7	3.51~5	3~8	3~8
YLF43—D8—P5—L5	8	4.51~6	3~8	3~8

□ Optional Processing

Part Number	0.01 mm Inc.		0.1 mm Inc.		Optional processing Code
Code	D	P	L	L	
YLF43	30	20.51~24	10~37	10~37	TD DARE
YLF43—D35—P26—L50—TD4	35	25.01~29	12~32	12~32	



Per	1~4	5~
Price	100%	Additional quotation



Delivery	10
① Surface free treatment	

Delivery	11
② Surface finish	

with Shoulder, L Configurable, Standard

Standard		L Size	Material		Hardness	Surface Treatment
Dp6	Dm6		GB	Equiv.		
YLC01	YLC21	Configurable	T10(A)	SKS93	48~58HRC	—
—	YLC22		9Cr18Mo	SUS440C	48~53HRC	Black Oxide
YLC16	—		—	—	—	—

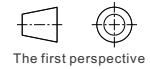
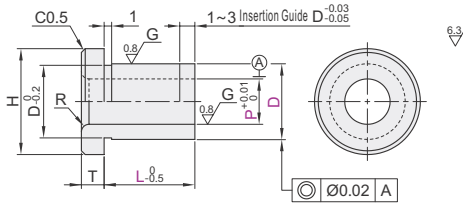

Part Number Code	D	D Tol.		0.01 mm Inc.		0.1 mm Inc.		R	H	T
		p6	m6	P	L					
Dp6 YLC01 YLC16	5	+0.020 +0.012	+0.004	2.20~2.50	3.0~5.5	0.8	9	2.5		
	7	+0.024 +0.015	+0.006	2.20~3.50	3.0~8.0	1.0	12	3		
	8	+0.024 +0.015	+0.006	3.00~4.50	3.0~12.0	1.0	12	3		
	10	+0.029 +0.018	+0.007	4.00~6.50	3.0~17.0	1.0	14	3		
	12	+0.029 +0.018	+0.007	6.00~8.50	3.0~17.0	1.0	16	3		
	15	+0.029 +0.018	+0.007	8.00~10.50	3.0~17.0	1.0	19	4		
Dm6 YLC21 YLC22	18	+0.029 +0.018	+0.007	10.00~12.50	3.0~17.0	1.0	22	4		
	20	+0.035 +0.022	+0.008	12.00~13.50	10.0~37.0	2.0	26	5		
	22	+0.035 +0.022	+0.008	13.00~15.50	10.0~37.0	2.0	26	5		
	25	+0.042 +0.026	+0.009	15.00~16.50	12.0~52.0	3.0	30	6		
	26	+0.042 +0.026	+0.009	16.00~20.50	12.0~52.0	3.0	35	6		
	30	+0.042 +0.026	+0.009	20.00~25.00	12.0~52.0	3.0	40	6		
	35	+0.042 +0.026	+0.009	20.00~25.00	12.0~52.0	3.0	40	6		



Code	Spec.
TD()	Change Shoulder Thickness [Ordering Code] TD4 [T] 1 mm Inc. [T] Applicable when D≥12.
DA	Adds an Adhesive Eservoir Groove When L≤13.0 [T] When L≤13, 2 oil grooves are processed. When L>13, 3 oil grooves will be processed. When D≤13, D-P≥3. When D≥14, D-P≥4. Only applicable to standard types and L>9 and above specifications.
RE	Machines Radius R on Both Sides [Ordering Code] RE [T] Applicable to Thickness 1.5 mm or more. [T] Size of R will be the same as R on shoulder side with D dimension 10 or more.

Code	Spec.																																				
ME()	Add Snap Ring Groove [Ordering Code] ME2.0 [T] Only applicable to standard type L10 and above. [T] For the detailed dimensions of the retaining ring groove, see P125.																																				
	<table border="1"> <thead> <tr> <th>D</th> <th>M</th> <th>ME 0.1 mm Inc.</th> </tr> </thead> <tbody> <tr><td>8</td><td>0.9</td><td>1.9~3.0</td></tr> <tr><td>10</td><td></td><td></td></tr> <tr><td>12</td><td>1.15</td><td>2.2~4.0</td></tr> <tr><td>15</td><td></td><td></td></tr> <tr><td>18</td><td>1.35</td><td>2.4~5.0</td></tr> <tr><td>20</td><td></td><td></td></tr> <tr><td>22</td><td>1.35</td><td>2.4~5.0</td></tr> <tr><td>25</td><td></td><td></td></tr> <tr><td>26</td><td></td><td></td></tr> <tr><td>30</td><td>1.65</td><td>2.7~5.0</td></tr> <tr><td>35</td><td></td><td></td></tr> </tbody> </table>	D	M	ME 0.1 mm Inc.	8	0.9	1.9~3.0	10			12	1.15	2.2~4.0	15			18	1.35	2.4~5.0	20			22	1.35	2.4~5.0	25			26			30	1.65	2.7~5.0	35		
D	M	ME 0.1 mm Inc.																																			
8	0.9	1.9~3.0																																			
10																																					
12	1.15	2.2~4.0																																			
15																																					
18	1.35	2.4~5.0																																			
20																																					
22	1.35	2.4~5.0																																			
25																																					
26																																					
30	1.65	2.7~5.0																																			
35																																					



Part Number	D	P	L
YLC01	5	2.2-2.5	3-5.5
		2.2-3	3-8.0

YLC01—D7—P3—L5

Optional Processing

Part Number	D	P	L	Optional processing Code
YLC01	5	2.2-2.5	3-5.5	TD() ME()
		2.2-3	3-8.0	RE

YLC01—D7—P3—L5—DA



Per	1~4	5~
Price	100%	Additional quotation

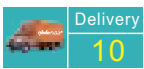

[T] Surface free treatment [T] Surface finish

No Shoulder/with Shoulder(Copper Alloy)

Code	Type	Tol.	Material
YLL91	No Shoulder	Pp6	High-tensile Brass
YLF81	with Shoulder	Pp6	
YLF86		Pm6	



No Shoulder
YLL91

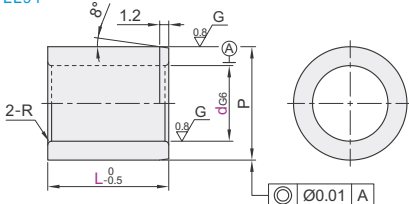

with Shoulder
YLL81/86

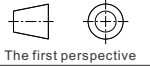
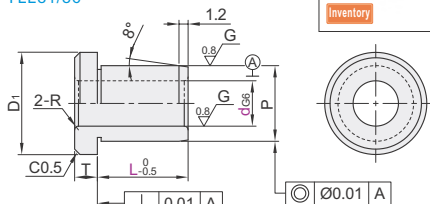

Part Number Code	d66	L				R	P	P Tol.		with Shoulder	
		p6	m6	D1	T			p6	m6		
No Shoulder (Pp6) YLL91	5	+0.012 +0.004	5 6 8 10 12 15			0.5	10	+0.024 +0.015	+0.015 +0.006	13.5	3
	6	+0.014 +0.005	5 6 8 10 12 15 16								
	8		5 6 8 10 12 15 16 20								
	10		6 8 10 12 15 16 20 25								
with Shoulder (Pp6) YLF81 (Pm6) YLF86	12		8 10 12 15 16 20 25 30			1	18	+0.029 +0.018	+0.018 +0.007	21.5	4
	13		10 12 15 16 20 25 30								
	15	+0.017 +0.006	12 15 16 20 25 30								
	16		12 15 16 20 25 30								
	20		12 15 16 20 25 30								
	25	+0.020 +0.007	16 20 25 30 35								
	35	+0.042 +0.026	16 20 25 30 35								



Part Number	d	L
YLF81	6	8 10 12
YLF86	12	8 10 12

YLF81—d10—L8



Per	1~9	10~
Price	100%	Additional quotation

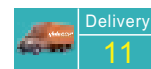

Fully Threaded Shank Pins

Code	Type	Material		Hardness	Surface Treatment
		GB	Equiv.		
YLN02	Fully Threaded Shank Pins	9CrWMn	SKS3	Treated Hardness: 53-58HRC, Plating Hardness: 850HV-	Hard Chrome Plating, Plating Thickness: 3-5 μm
YLN11		0Cr18Ni9	SUS304		

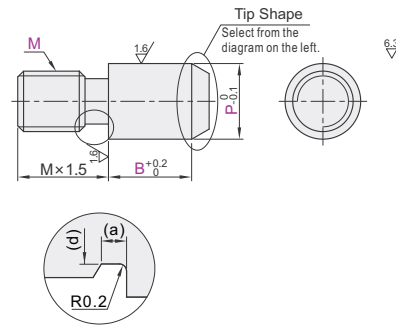
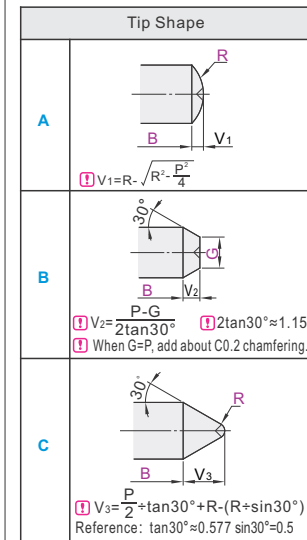

M	(a)	(d)
3	1.3	2.2
4	1.8	2.9
5	2	3.7
6	2.5	4.4
8	3.1	6
10	3.7	7.7
12	4.4	9.4
16	5	13
20	6.3	16.4

Ⓜ Above dimensions are for reference and not guaranteed.



Code	Tip Shape	M	P 0.1 mm Inc.	B 0.1 mm Inc.	R 1 mm Inc.	G 1 mm Inc.
					A Shape only, C Shape	B Shape only
YLN02 (SKD11)	A	3	3.5~8.0		Shape A R ≥ P/2	Shape B R ≤ P
		4	4.5~8.0	1.0~12.0		
		5	5.5~8.0			
YLN11 (SUS304)	B	6	6.5~10.0	1.0~15.0		
		8	9.0~15.0	1.0~30.0		
	C	10	11.0~17.0	3.0~30.0		
		12	13.0~20.0			
		16	17.0~27.0	5.0~30.0		
		20	21.0~30.0			

Code	TA	HC()	SA()																																						
Optional Processing Spec.	Wrench Hole (Ø3.5) 	Wrench Flats 	Hex Socket Machining 																																						
	Ordering Code: TA Adds a Ø3.5 hole. Ⓜ Not applicable when B ≤ 10, P ≤ 8.	Ordering Code: HC10 Ⓜ 1 mm Inc. Ⓜ Not applicable when B ≥ 11 or greater.	Ordering Code: SA3 <table border="1"> <thead> <tr> <th>G</th> <th>B</th> <th>S</th> <th>S</th> <th>E</th> </tr> </thead> <tbody> <tr><td>4-5</td><td></td><td>2 2.5</td><td>2</td><td>2</td></tr> <tr><td>6-7</td><td>10~</td><td>2 2.5 3 4</td><td>2.5</td><td>2</td></tr> <tr><td>8-9</td><td></td><td>2 2.5 3 4 5</td><td>3</td><td>2</td></tr> <tr><td rowspan="2">10-30</td><td>10~12.9</td><td>2 2.5 3 4 5 6</td><td>4</td><td>2.5</td></tr> <tr><td>13</td><td>2 2.5 3 4 5 6 8</td><td>5</td><td>3</td></tr> <tr><td></td><td></td><td></td><td>6</td><td>4</td></tr> <tr><td></td><td></td><td></td><td>8</td><td>5</td></tr> </tbody> </table> Ⓜ A-shaped and c-shaped are not applicable. Ⓜ Applicable to Shape B with M ≥ 6 only	G	B	S	S	E	4-5		2 2.5	2	2	6-7	10~	2 2.5 3 4	2.5	2	8-9		2 2.5 3 4 5	3	2	10-30	10~12.9	2 2.5 3 4 5 6	4	2.5	13	2 2.5 3 4 5 6 8	5	3				6	4				8
G	B	S	S	E																																					
4-5		2 2.5	2	2																																					
6-7	10~	2 2.5 3 4	2.5	2																																					
8-9		2 2.5 3 4 5	3	2																																					
10-30	10~12.9	2 2.5 3 4 5 6	4	2.5																																					
	13	2 2.5 3 4 5 6 8	5	3																																					
			6	4																																					
			8	5																																					

Part Number	Code	Tip Shape	M	P 0.1 mm Inc.	B 0.1 mm Inc.	R 1 mm Inc.
YLN02	A	3	3.5~8.0			Shape A
YLN11	B	4	4.5~8.0	1.0~12.0		Shape A R ≥ P/2

YLN02-A-M4-B6-R6

Optional Processing

Part Number	Code	Tip Shape	M	P 0.1 mm Inc.	B 0.1 mm Inc.	R 1 mm Inc.	Optional processing Code
YLN02	A	3	3.5~8.0	1.0~12.0		Shape A	TA HC() SA()
YLN11	B	4	4.5~8.0	1.0~12.0	1.0~12.0	Shape A R ≥ P/2	TA HC() SA()

YLN02-A-M16-P25-B20-R6-TA

Discount price

Per	1~19	20~
Price	100%	Additional Auction

Delivery

8

Delivery

11

Ⓜ Surface free treatment
No hardness

Ⓜ Surface finish



Code	Type	Shape	Material		Hardness	Surface Treatment
			GB	Equiv.		
YLP01	Round Flange	Round	9CrWMn	SKS3	Treated Hardness:58~61HRC	—
YLP21		Diamond	9CrWMn	SKS3	Treated Hardness:58~61HRC	
YLP41	Compact Flange	Round	9CrWMn	SKS3	Treated Hardness:58~61HRC	Hard Chrome Plating, Plating Thickness: 3~5 μm
YLP52			0Cr18Ni9	SUS304	Plating Hardness: 850HV~	
YLP61		Diamond	9CrWMn	SKS3	Treated Hardness:58~61HRC	—

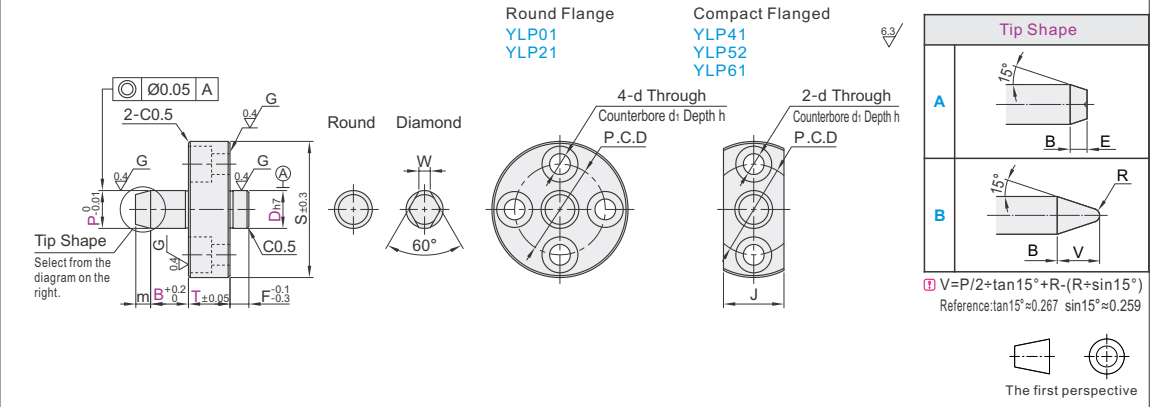

Part Number			P	B	T	F	S	J	P-C-D	d	d ₁	h	E	R	W	
Code	Tip Shape	D _{h7}	0.01 mm Inc.	0.1 mm Inc.	0.1 mm Inc.											
Round Flange YLP01 YLP21	A	5	3.00~6.00	3.0~12.0	5.0~10.0	5	25	11	16	3.5	6.5	3.5	3	1	1.5	
		6	4.00~7.00	3.0~15.0												1.8
		8	6.00~9.00	3.0~17.0											1.5	2.2
Compact Flange YLP41 YLP52 YLP61	B	10	7.00~11.00	4.0~22.0	7.0~15.0	5	36	16	24	5.5	9.5	5.5	4	2	3	
		12	8.00~12.00	4.0~22.0										3	3.2	
		16	13.00~16.00	5.0~22.0	11.0~20.0	10	54	24	37	9	14	9	5	4	4	
		20	16.00~20.00	5.0~22.0										5	5.5	



Part Number			P	B	T
Code	Tip Shape	D	0.01 mm Inc.	0.1 mm Inc.	0.1 mm Inc.
YLP01	A	5	3.00~6.00	3.0~12.0	5.0~10.0
YLP21	B	6	4.00~7.00	3.0~15.0	

YLP01 - B - D6 - P6 - B4 - T6



Discount price		
Per	1~10	11~
Price	100%	Additional quotation

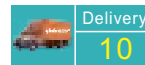

Surface free treatment

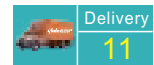

Surface finish

Marker Pins/Feed Pins

Marker Pins

Code	Type	Material		Hardness	Surface Treatment
		GB	Equiv.		
YMC11	Hex Socket Type	0Cr18Ni9	SUS304	—	—



Self-made

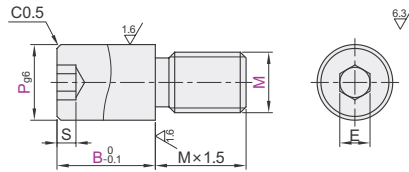

P Tol.

P	g6
5.0~6.0	-0.004 -0.012
6.1~10.0	-0.005 -0.014
10.1~15.0	-0.006 -0.017

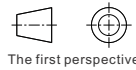

Part Number		P	B	S	E
Code	M	0.1 mm Inc.	0.1 mm Inc.		
YMC11	3	5.0~6.0	6.5~12.0	2	2
	4	5.0~7.0	6.5~12.0	2	2.5
	5	6.0~8.0	6.5~12.0	2	3
	6	6.5~10.0	6.5~15.0	2	3
	8	8.5~12.0	7.5~15.0	2.5	4
	10	10.5~15.0	8.5~15.0	3	5



Please order as shown

Part Number	P	B
Code	M	0.1 mm Inc.
YMC11	3	5.0~6.0 6.5~12.0
	4	5.0~7.0 6.5~12.0
	5	6.0~8.0 6.5~12.0
	6	6.5~10.0 6.5~15.0
	8	8.5~12.0 7.5~15.0
	10	10.5~15.0 8.5~15.0

YMC11—M4—P6—B8



Discount price	Per	1~4	5~
Price	100%	Additional quotation	



Delivery	8
----------	---

Feed Pins

Code	Type	Material		Hardness	Surface Treatment
		GB	Equiv.		
YMF06	Round	0Cr18Ni9	SUS304	Plating Hardness:850HV~	Hard Chrome Plating , Plating Thickness: 5~8 μm



Self-made

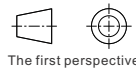
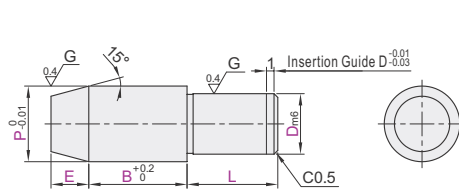

Part Number		0.01 mm Inc.	1 mm Inc.	0.1 mm Inc.	
Code	D _{m6}	P	L	B	E
YMF06	2	2.50~5.00	2~8	2.0~10.0	0.5~10.0
	3	3.50~5.00	3~8		
	4	4.50~7.00	4~10		
	5	5.50~8.00	5~12		
	6	6.50~10.00	6~15		
	8	9.00~13.00	8~18		
	10	10.00~13.00	10~22	2.0~20.0	



Please order as shown

Part Number	0.01 mm Inc.	1 mm Inc.	0.1 mm Inc.
Code	D	P	L B E
YMF06	2	2.5~5	2~8 2~8 0.5~10
	3	3.5~5	3~8 3~8 0.5~10
	4	4.5~7	4~10 4~10 0.5~10
	5	5.5~8	5~12 5~12 0.5~10
	6	6.5~10	6~15 6~15 0.5~10
	8	9.0~13	8~18 8~18 0.5~10
	10	10.0~13	10~22 10~22 0.5~10

YMF06—D3—P4—L5—B5—E5



Discount price	Per	1~19	20~
Price	100%	Additional quotation	



Delivery	11
----------	----